

## Madison High School Modernization

Board of Education Meeting

Portland Public Schools

August 28, 2018



opsis + dao

### Agenda

1. Gymnasium – New-Build Design
2. CTE – Revised Plan / Expansion Alternate
3. Total Project Budget

MADISON HIGH SCHOOL MODERNIZATION | Board of Education Meeting, August 28, 2018

opsis + dao

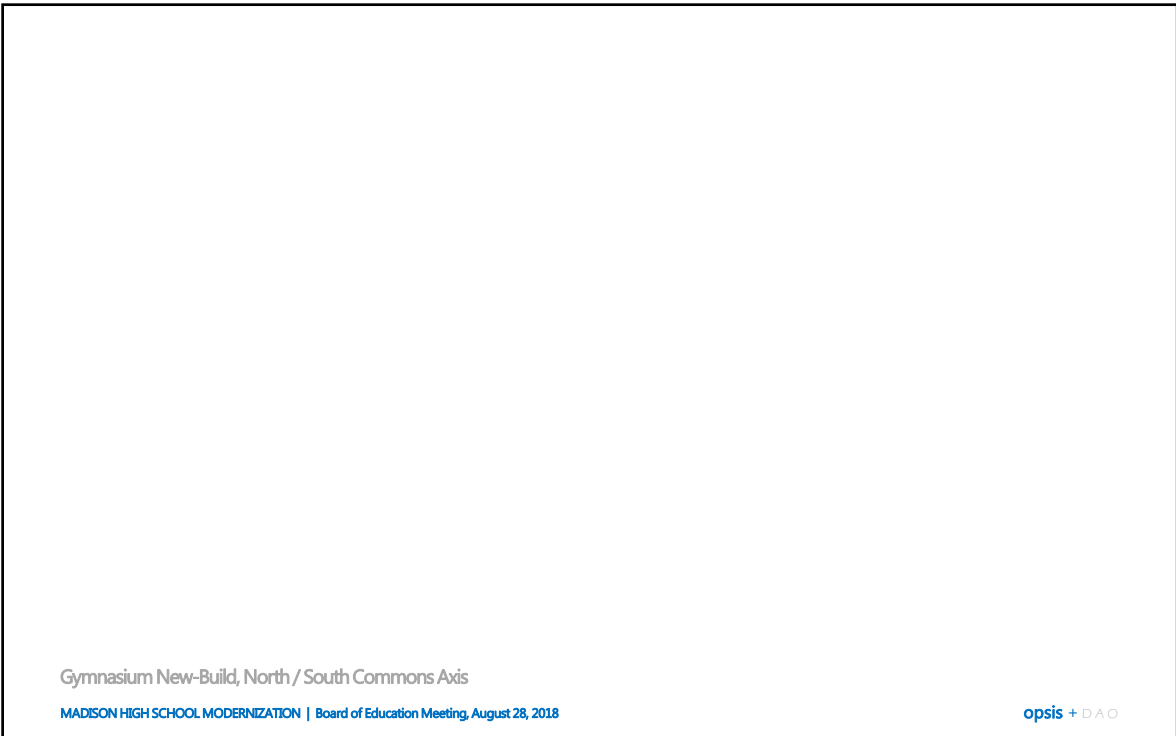

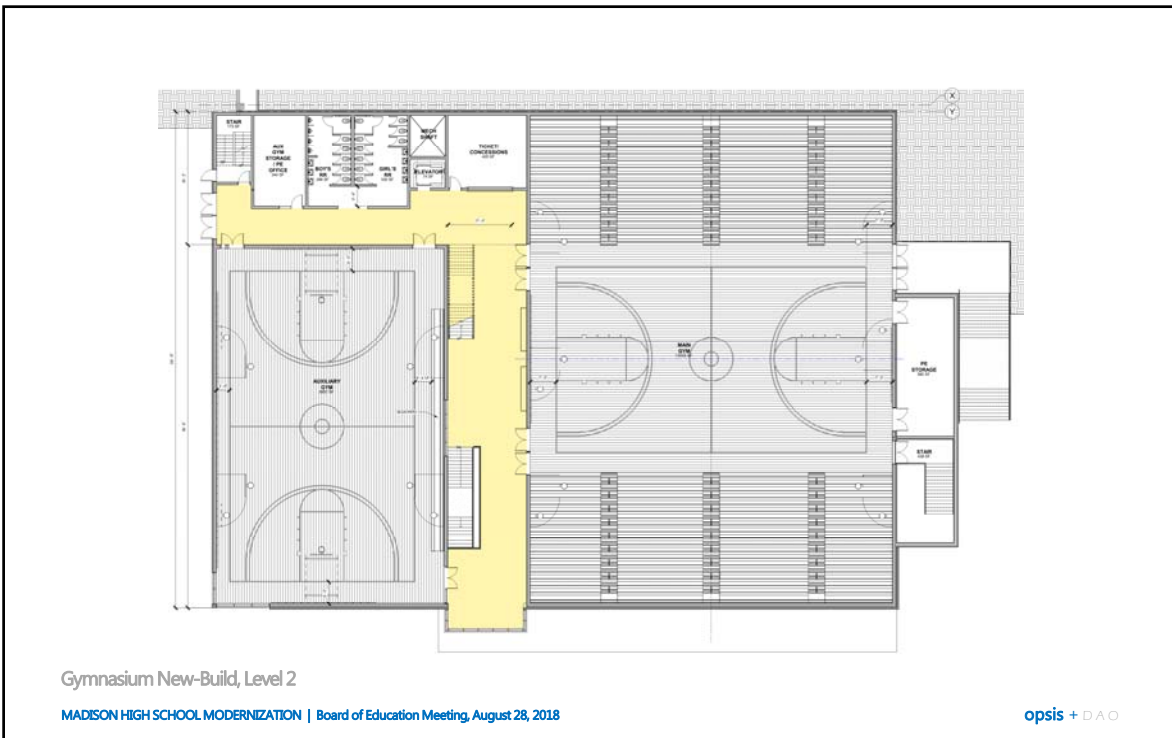
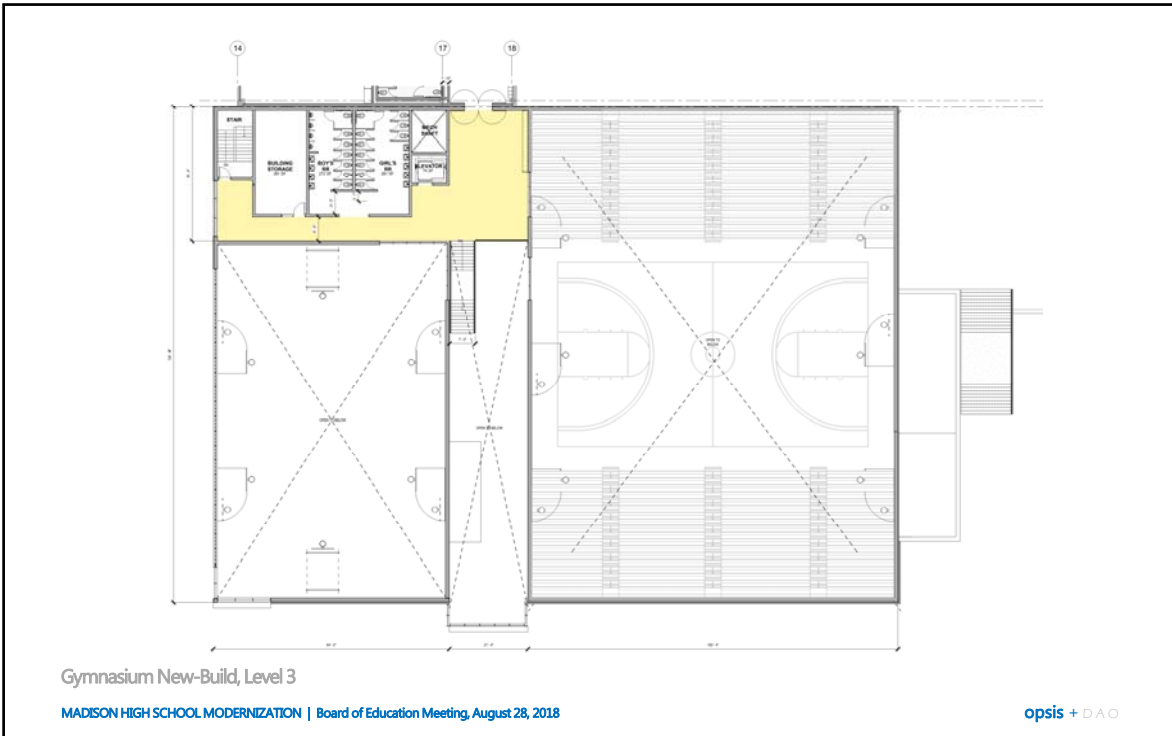

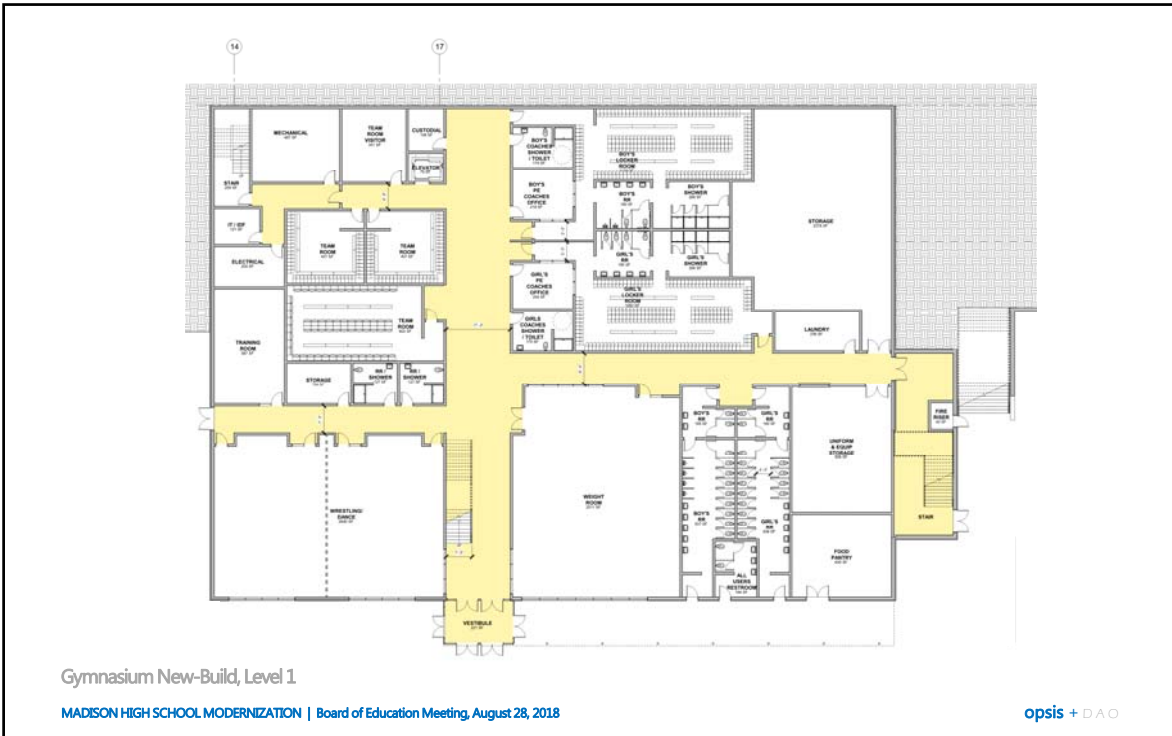



Render of Gymnasium New-Build, Interior

MADISON HIGH SCHOOL MODERNIZATION | Board of Education Meeting, August 28, 2018

opsis + dao



Gymnasium New-Build, Cross Sections

MADISON HIGH SCHOOL MODERNIZATION | Board of Education Meeting, August 28, 2018

opsis + dao

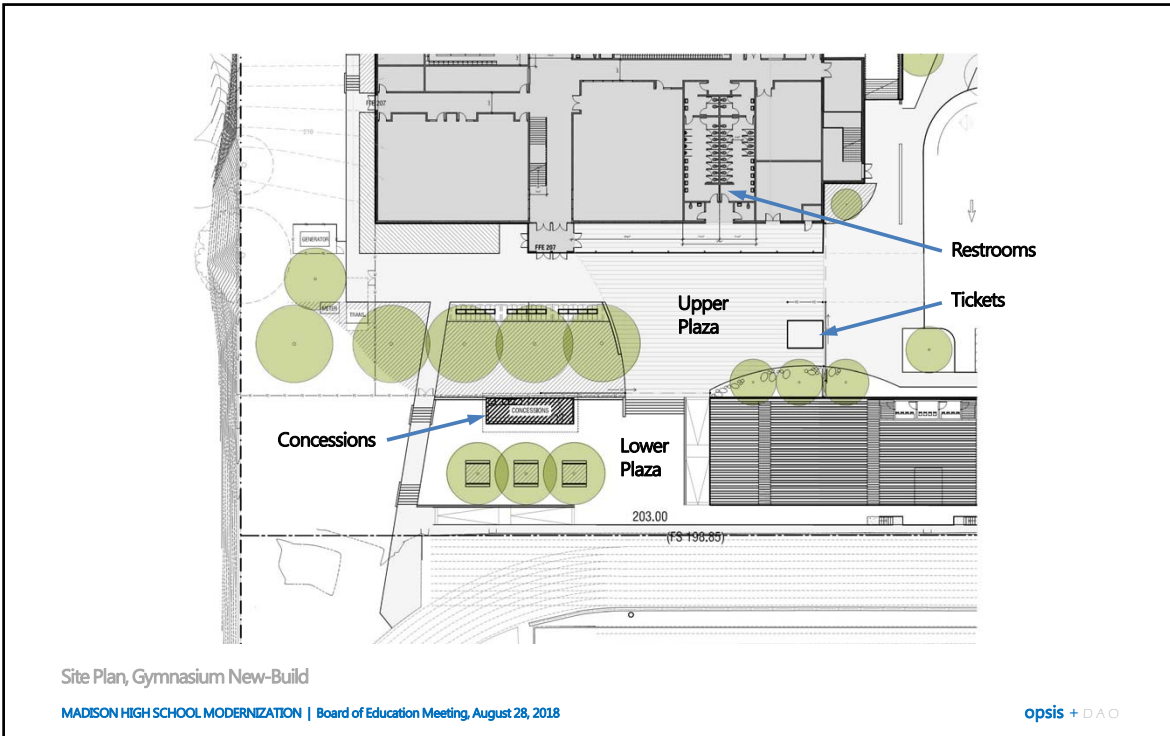

### Gymnasium New-Build — Area / Cost Comparison

| Ed Spec                                      | 100% Schematic Design Option   | New Gym Option                               |
|--|--|--|
| <b>MAIN PROGRAMMATIC SPACES</b>              | <b>MAIN PROGRAMMATIC SPACES</b>  | <b>MAIN PROGRAMMATIC SPACES</b>              |
| Gym 13,000 sf                                | Main Gym 13,692 sf   | Main Gym 13,032 sf                           |
| Gym (auxiliary - practice) 5,700 sf          | Auxiliary Gym 5,791 sf   | Auxiliary Gym 5,957 sf                       |
| Auxiliary Gym Bleachers 1,000 sf             |  |  |
| Weight Rm / Aerobics / Spinning 2,500 sf     | Weight Room 2,338 sf   | Weight Room 2,511 sf                         |
| Mat / Wrestling / Dance 2,750 sf             | Wrestling / Dance 2,855 sf   | Wrestling / Dance 2,644 sf                   |
| Training Room 580 sf                         | Training Room 725 sf   | Training Room 587 sf                         |
| Laundry Room 200 sf                          | Laundry 217 sf   | Laundry 236 sf                               |
| Concessions 100 sf                           | Concessions / Tickets 302 sf   | Concessions 420 sf                           |
| <b>TOTAL 25,830 sf</b>                       | <b>TOTAL 25,920 sf</b>   | <b>TOTAL 25,387 sf</b>                       |
| <b>TEAM ROOMS</b>                            | <b>TEAM ROOMS</b>  | <b>TEAM ROOMS</b>                            |
| Team Room 800 sf                             | Team Room 815 sf   | Team Room 407 sf                             |
|  | Team Room 896 sf   | Team Room 407 sf                             |
|  | Team Room 809 sf   | Team Room 802 sf                             |
|  | Team Room 786 sf   | Team Room Visitor 341 sf                     |
|  | Team Room 744 sf   |  |
| <b>TOTAL 800 sf</b>                          | <b>TOTAL 4,050 sf</b>  | <b>TOTAL 1,957 sf</b>                        |
| <b>TOTAL PE / ATHLETICS NET SF 34,580 sf</b> | <b>TOTAL PE / ATHLETICS NET SF 37,177 sf</b>                               | <b>TOTAL PE / ATHLETICS NET SF 34,494 sf</b> |
|  | <b>GROSS SF 63,888* sf</b>   | <b>GROSS SF 55,330 sf</b>                    |
|  | <small>* Includes unrenovated 4,412 sf "schoolhouse supplies" area</small> |  |
|  | <b>Total Hard Cost \$30,193,004</b>  | <b>\$26,958,329</b>                          |
|  | <b>Savings</b>   | <b>\$3,234,675</b>                           |

MADISON HIGH SCHOOL MODERNIZATION | Board of Education Meeting August 28, 2018

opis + DAO

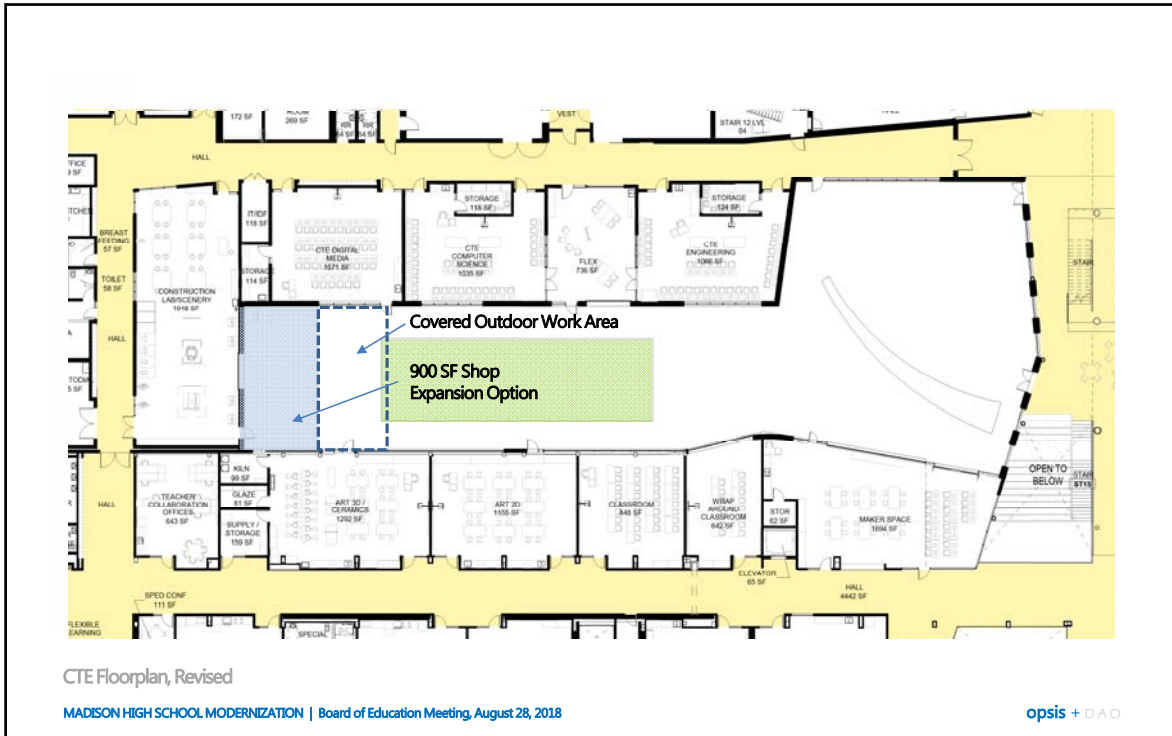

### Madison Total Project Budget

August 28, 2018

| Component               | Comments   | Cost                 |
|-------------------------|--|----------------------|
| Hard Costs              | Renovated building and site work   | \$147,511,000        |
|                         | * Two estimates provided by Fortis Construction and by RLB Cost Estimators, based on 100% Schematic Design and subsequent value engineering effort |                      |
| 1.5% Renewable Energy   | Required by the State of Oregon  | \$2,239,000          |
| Off Site Improvements   | Street and signalization improvements required by PBOT and ODOT  | \$1,750,000          |
| <b>TOTAL HARD COSTS</b> |  | <b>\$151,500,000</b> |
| Soft Costs              | Design, permit fees, moving costs, etc.  | \$16,342,000         |
| Furniture & Equipment   | Based on current PPS standards   | \$7,301,500          |
| Project Contingency     | 13.6% of total project costs   | \$23,856,500         |
| Escalation              | Included in hard costs   | \$0                  |
| <b>TOTAL</b>            |  | <b>\$199,000,000</b> |

MADISON HIGH SCHOOL MODERNIZATION | Board of Education Meeting, August 28, 2018

opsis + DAO