

Benson Campus
Multiple Pathways to
Graduation
Space Analysis

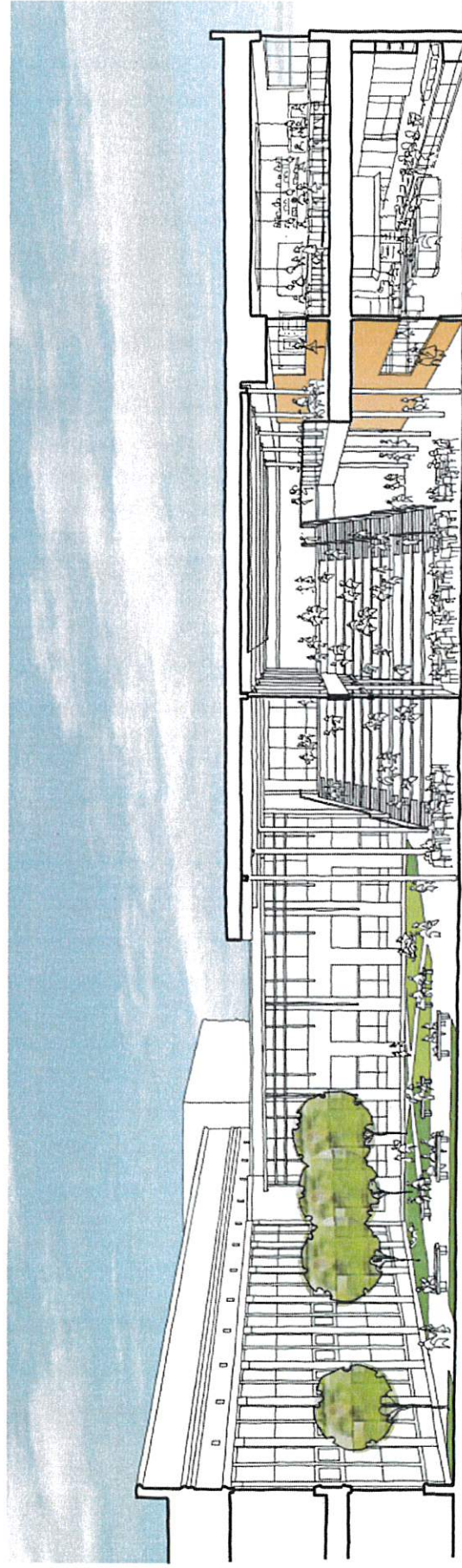

February 19, 2019

Board's Charge



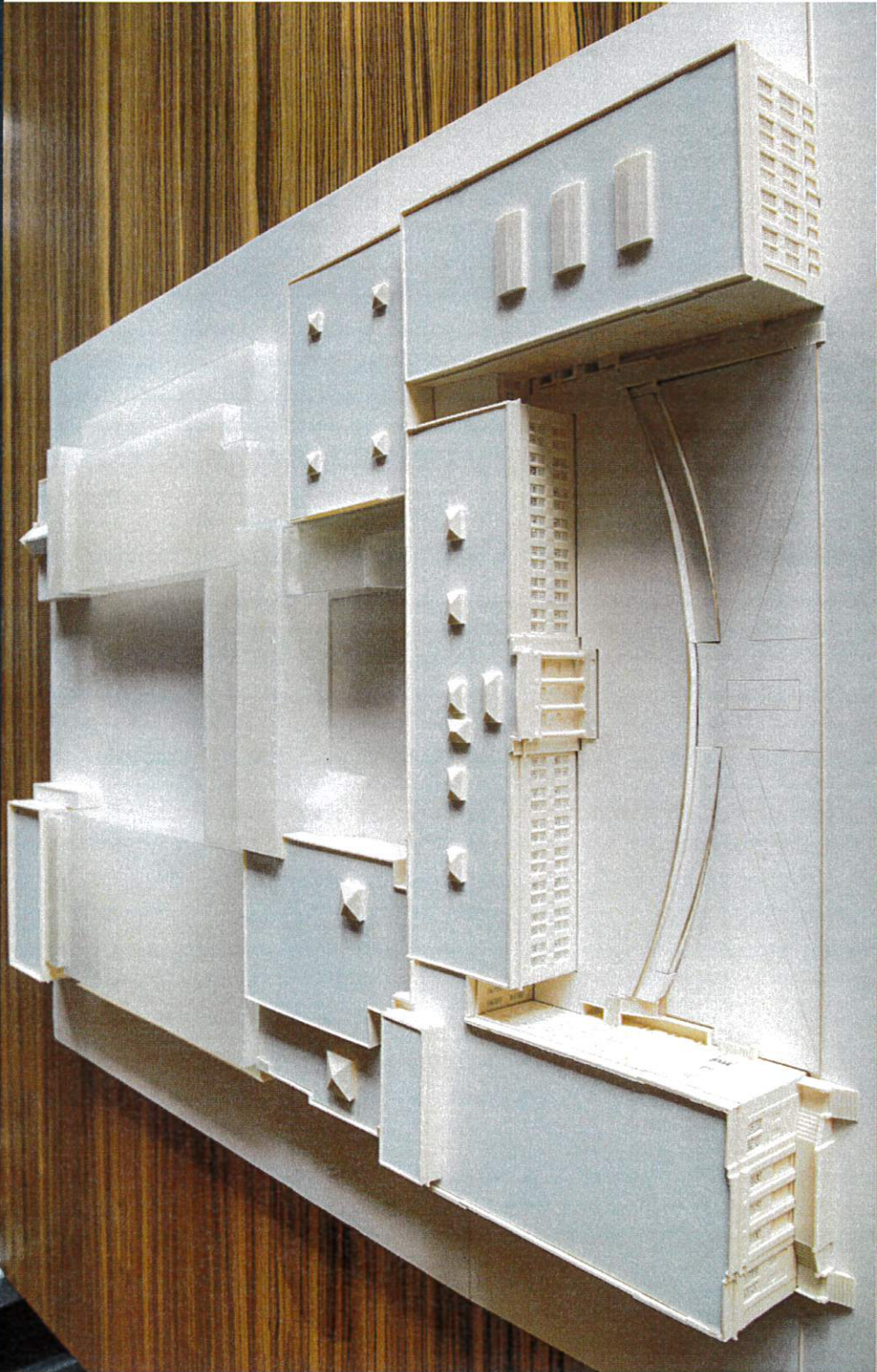

Community Engagement Process

- November 26 Alliance at Benson
- December 12 Evening Scholars, Summer Scholars
- January 17 Alliance at Meek
- January 22 DART/Clinton
- January 24 Reconnection Services, Teen Parents
- January 30 Portland International Scholars Academy

Community Voices

Learning Environment

- Smaller more therapeutic space
- Classrooms, private offices, confidential conference
- Small community feel
- Choice of electives
- Physical education

Community Voices

Access & Facility

- Central location
- Multiple transportation options
- Childcare
- Separate entries
- Cafeteria and access to kitchen
- Food pantry
- Separate and adequate restrooms

Principals & School Modernization Team

- Reviewed the community input
- Identified the needs of each program
- Created scenarios

ON-SITE SCENARIOS OVERVIEW

- SCENARIO 1 / NO MPG PROGRAMS ON-SITE
- SCENARIO 2A / ALL MPG PROGRAMS ON-SITE
- SCENARIO 2B / ALL MPG PROGRAMS ON-SITE
ADDITIONAL CRS FOR BENSON TECH
- SCENARIO 3A / INTEGRATED MPG PROGRAMS ON-SITE (MAIN BLDG)
- SCENARIO 3B / INTEGRATED MPG PROGRAMS ON-SITE (MAIN BLDG)
ADDITIONAL CRS FOR BENSON TECH
- SCENARIO 3C / INTEGRATED MPG PROGRAMS ON-SITE (LOWER LEVEL)
- SCENARIO 3D / INTEGRATED MPG PROGRAMS ON-SITE (LOWER LEVEL)
ADDITIONAL CRS FOR BENSON TECH
- SCENARIO 4A / INTEGRATED MPG PROGRAMS ON-SITE (MAIN BLDG),
INDEPENDENT SCHOOLS ON ADJACENT PARKING SITE
- SCENARIO 4B / INTEGRATED MPG PROGRAMS ON-SITE (MAIN BLDG),
INDEPENDENT SCHOOLS ON ADJACENT PARKING SITE
ADDITIONAL CRS FOR BENSON TECH
- SCENARIO 4C / INTEGRATED MPG PROGRAMS ON-SITE (LOWER LEVEL),
INDEPENDENT SCHOOLS ON ADJACENT PARKING SITE
- SCENARIO 4D / INTEGRATED MPG PROGRAMS ON-SITE (LOWER LEVEL),
INDEPENDENT SCHOOLS ON ADJACENT PARKING SITE
ADDITIONAL CRS FOR BENSON TECH

SCENARIO 4B / SITE PLAN

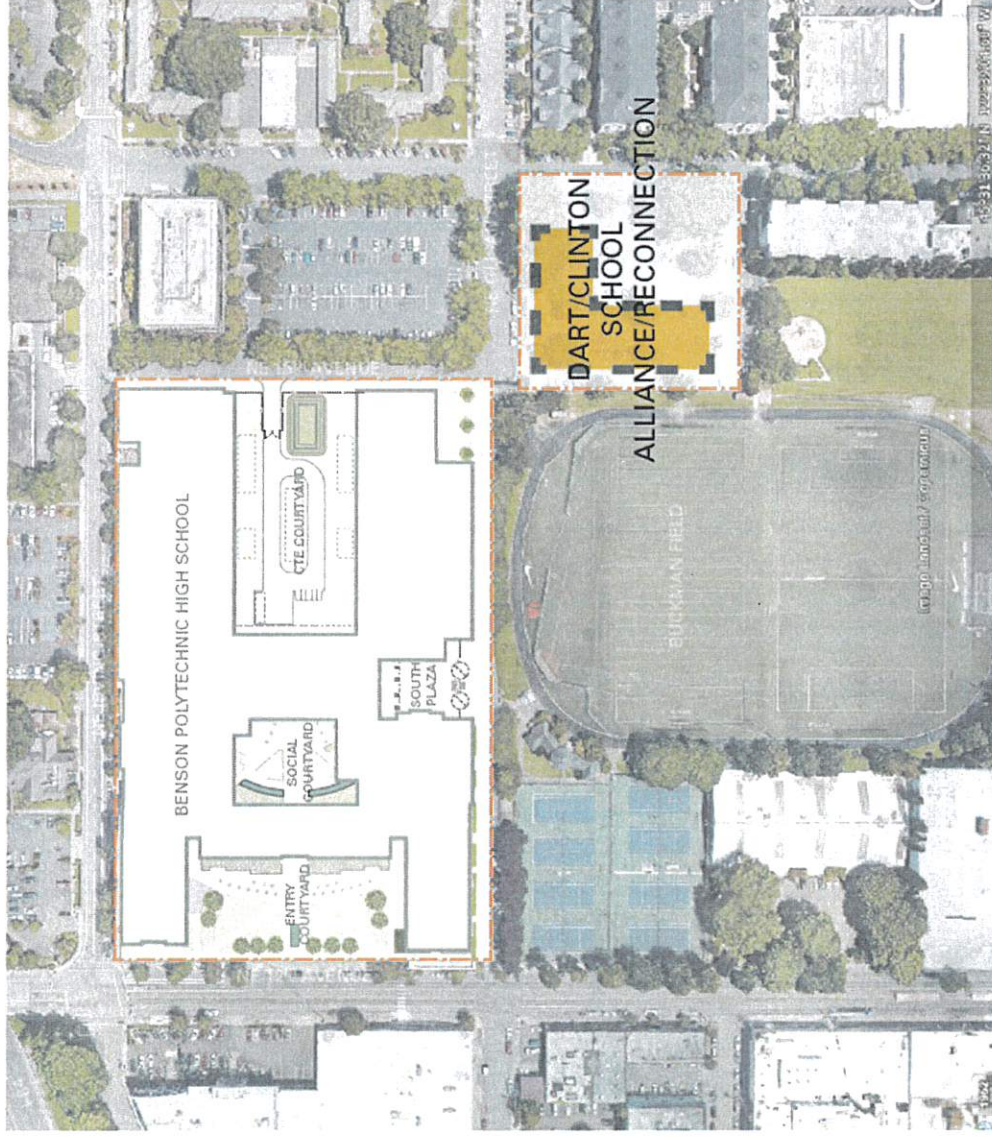

SCENARIO 4B / UPPER LEVEL

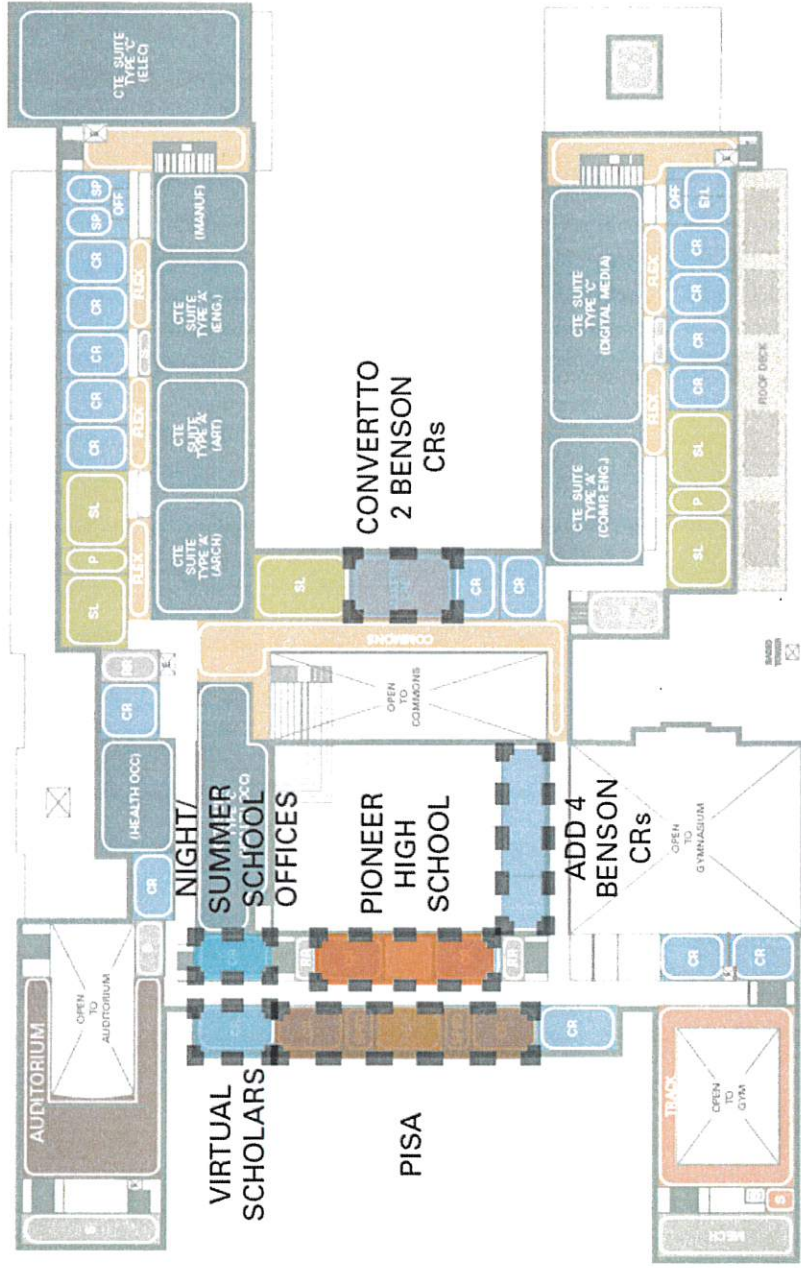

LEGEND

Yellow box	GATHERING SPACE	Green box	SL (WORK/LAB)	Blue box	PERFORMING ARTS
Light blue box	CTE	Orange box	ATHLETICS	Dark blue box	SPECIALTY RESOURCE
Dark blue box	CR (CLASSROOM)	Light blue box	SUPPORT	Light green box	ADMIN/EXTP/TECHNICAL PLANNING
Light blue box	SP (SPECIAL EDUCATION)				



SCENARIO 4B / LOWER LEVEL

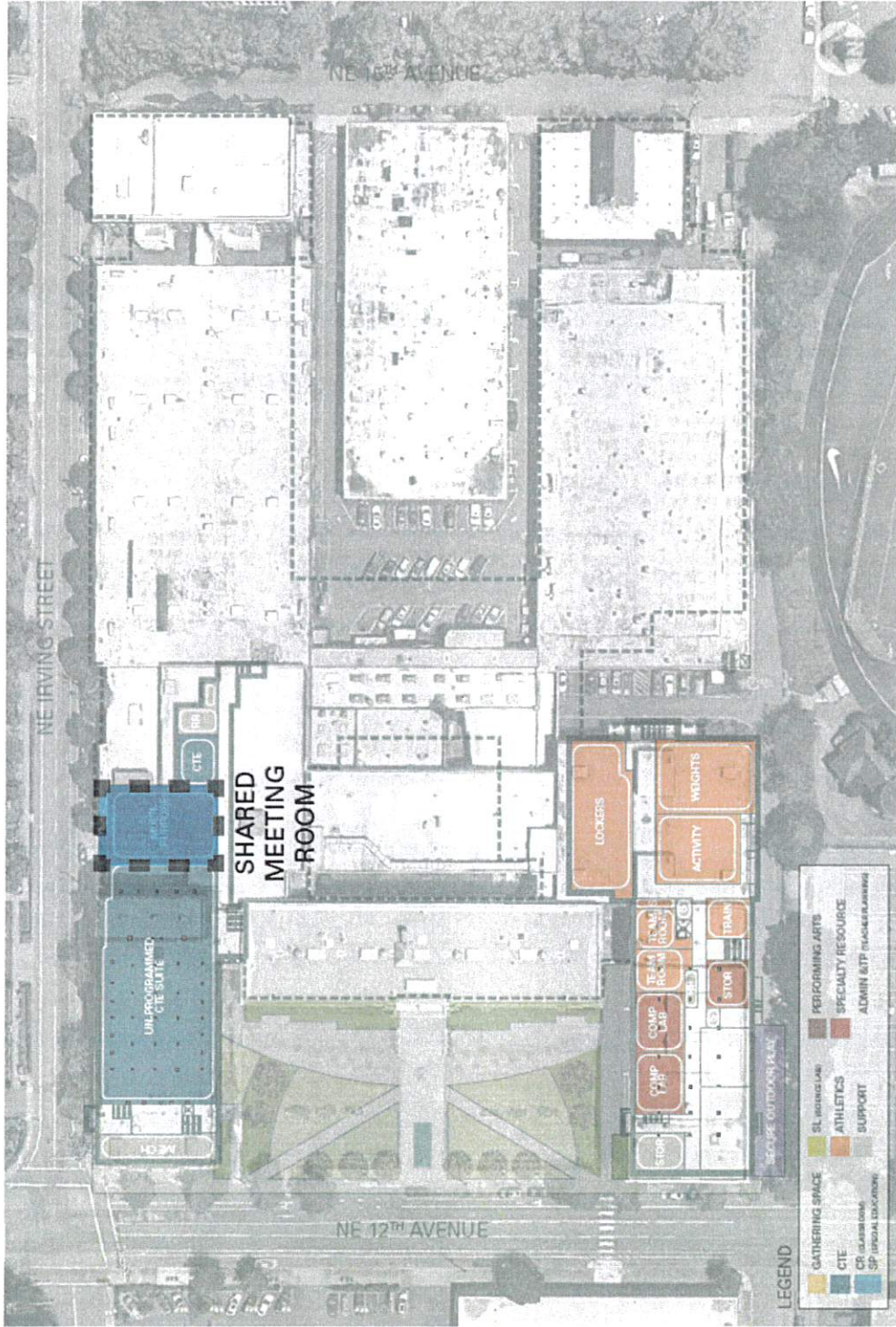

Preliminary Cost Estimate Ranges

OPTION	DESCRIPTION	COST RANGE	
		LOW	HIGH
4B	• New Building for Alliance, DART/Clinton	24,000,000	36,000,000
	• (4) Added Classroom in Benson	3,000,000	3,500,000
	• Allowance for Kenton swing improvements	4,000,000	6,000,000
	• Allowance for Marshall HS swing improvements	5,000,000	8,000,000
	• Reduce swing space budget	(5,500,000)	(5,500,000)
	• Estimated schedule efficiency savings	(11,000,000)	(12,000,000)
	Subtotal		19,500,000
	Current Project Budget	296,000,000	296,000,000
	Option 4B Total	19,500,000	36,000,000
	Estimated Project Budget	315,500,000	332,000,000

Expands Opportunities for Benson High School Students

- Increases Career Technical Education (CTE) pathways
- Honors current Benson HS students participation in the Design Advisory Group (DAG)
- Allows for separate school space for Benson HS students
- Support for English language learners and special education students

Multiple Pathways Facility Needs Met

Alliance High School, Reconnection Center, Reconnection Services, DART Clinton School and Teen Parent Services learning environments will be comparable to modernization projects at other PPS High Schools.

- Adequate classroom, lab and meeting spaces
- Creation of trauma sensitive classrooms, schools
- Warm spaces to welcome PPS families districtwide
- Confidential meeting spaces
- Wrap around services

Multiple Pathways Students' Academic Needs Met

Increased student retention, achievement, graduation through:

- Personalized learning
- Enhanced Project Based Learning and Career Technical Education (CTE)
- Flexible schedules to meet the unique needs of individual students
- Maintain scheduling opportunities with Portland Evening Scholars
- Childcare for teen parents
- Expanding pathways to post-secondary
- Cultural or curricular large group / whole school gatherings

Next Steps

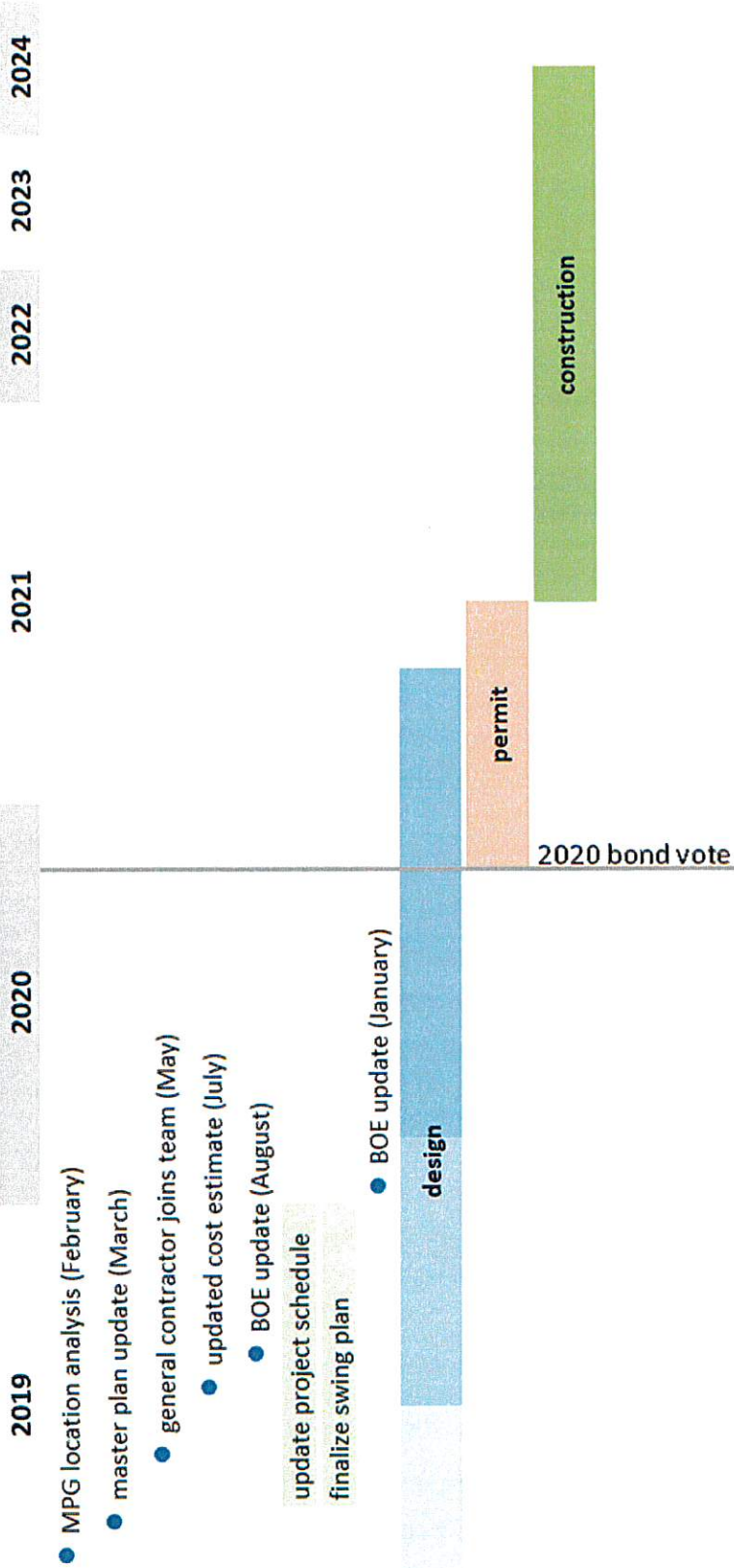

MPG SCENARIOS / SUMMARY

BENSONTECH MASTER PLAN BOARD RESOLUTION PROVISIONS											
	1	2A	2B	3A	3B	3C	3D	4A	4B	4C	4D
Building size reduction (about 3,500 SF)	☐					☐					
Space for future visual & performing arts program	●			●	●			●	●		
ADA/Code compliant access to Buckman Fields	●	●	●	●	●	●	●	●	●	●	●
PROGRAMS INCLUDED ON-SITE:											
Virtual Scholars		✓	✓	✓	✓	✓	✓	✓	✓	✓	✓
Night/Summer School Offices		✓	✓	✓	✓	✓	✓	✓	✓	✓	✓
PISA		✓	✓	✓	✓	✓	✓	✓	✓	✓	✓
Pioneer High School		✓	✓	✓	✓	✓	✓	✓	✓	✓	✓
DART/Clinton School		✓	✓	✓	✓	✓	✓	✓	✓	✓	✓
Alliance at Benson and Reconnection		✓	✓	✓	✓	✓	✓	✓	✓	✓	✓
IMPACTS TO APPROVED MASTER PLAN											
Approximate additional cost to project		\$	\$	\$	\$	\$	\$	\$	\$	\$	\$
Adaptive re-use of upper Auditorium balcony		●	●								
Requires off-site/alternative location(s) for MPG	●			●	●	●	●				
Reduces Benson Tech CTE space		●	●								●
# of fewer teaching stations for Benson Tech	0	-12	-6	-6	0	-6	0	-6	0	-6	0
Approx. Benson capacity reduction from 1,700	0	-300	-150	-150	0	-150	0	-150	0	-150	0
MPG in lower level, adequate but not ideal		●	●			●	●			●	●
Displacement of Benson Tech freshman academy		●	●	●	●			●	●		
Reduced Benson Tech storage		●	●			●	●			●	●
Reduced parking capacity								●	●	●	●

Discussion

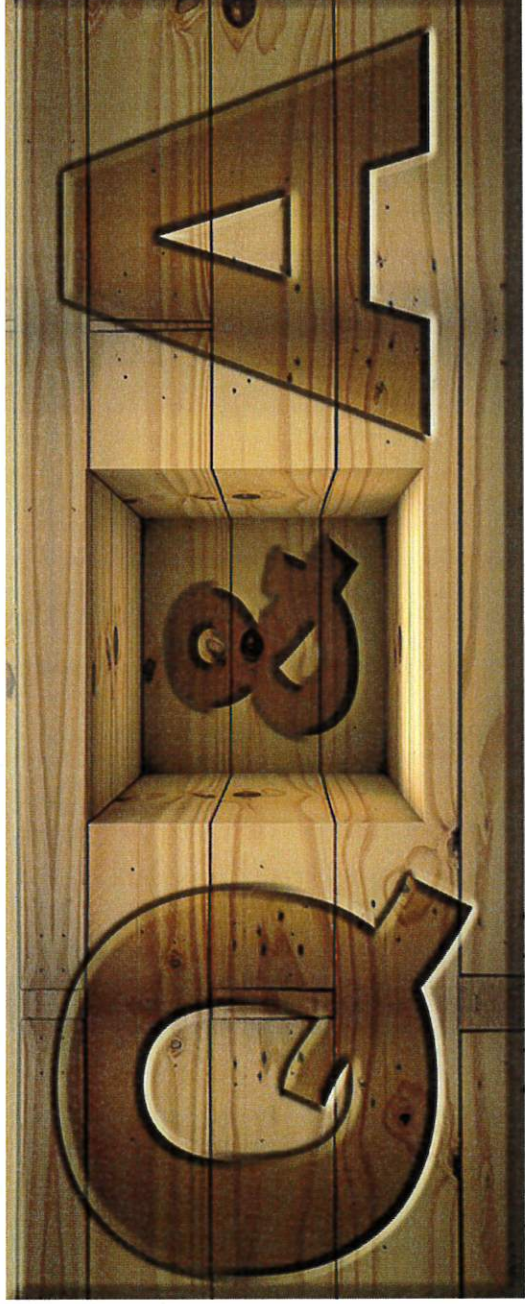

MPG DRAFT PROGRAMS / NET AREA

VIRTUAL SCHOLARS: 3,222 SF EXISTING AREA

PROGRAM	QUANTITY	AREA (SF)	TOTAL (SF)	CLASS SIZE	NOTES
DEDICATED CLASSROOMS W/ SMALL BREAKOUT	1	900	900	20 STUDENTS	
MULTI-PURPOSE ROOM	1	2500	2500	60 STUDENTS	COULD BE SHARED
TECH STORAGE	1	120	120		
			3,520		

NIGHT & SUMMER SCHOOL: 989 SF EXISTING AREA

PROGRAM	QUANTITY	AREA (SF)	TOTAL (SF)	CLASS SIZE	NOTES
OPEN OFFICE FOR 3 STAFF WAITING AREA	1	400	400		
PRIVATE OFFICES: PRINCIPAL, IT	2	80	160		
CONFERENCE ROOM	1	225	225		COULD BE SHARED
			785		

PISA: 2,568 SF EXISTING AREA

PROGRAM	QUANTITY	AREA (SF)	TOTAL (SF)	CLASS SIZE	NOTES
DEDICATED CLASSROOMS	2	900	1,800	20 STUDENTS	
SHARED CLASSROOMS	1	900	SHARED		
SHARED SCIENCE LAB	1	1,700	SHARED		
PRIVATE OFFICES: ADMIN, COUNSELOR, ENGAGEMENT COACH, EA, DATA SPECIALIST	5	80	400		
CONFERENCE ROOM	1	225	225		COULD BE SHARED
SECRETARY WAITING AREA	1	200	200		COULD BE SHARED
STAFF WORKROOM	1	260	260		COULD BE SHARED
			2,885		

PIONEER HIGH SCHOOL: 912 SF EXISTING AREA

PROGRAM	QUANTITY	AREA (SF)	TOTAL (SF)	CLASS SIZE	NOTES
DEDICATED CLASSROOMS	1	900	900	15 STUDENTS	
CONFERENCE ROOM	1	225	225		COULD BE SHARED
OFFICES: THERAPIST	1	80	80		
			1,205		

RECONNECTION CENTER: 751 SF EXISTING AREA

PROGRAM	QUANTITY	AREA (SF)	TOTAL (SF)	CLASS SIZE	NOTES
PRIVATE OFFICES: ADMIN	1	120	120		
CONFERENCE ROOM	1	225	225		COULD BE SHARED
OPEN OFFICE FOR 9 STAFF WAITING AREA	1	640	640		
			985		

MPG DRAFT PROGRAMS / NET AREA

DART / CLINTON SCHOOL: 7,123 SF EXISTING AREA

PROGRAM	QUANTITY	AREA (SF)	TOTAL (SF)	CLASS SIZE	NOTES
DEDICATED CLASSROOMS	4	900	3,600	10 STUDENTS	
PRIVATE OFFICES: PRINCIPAL, COUNSELOR, MSW, PSYCH (2), SPED	6	80	480		
CONFERENCE ROOM	2	225	450		
SECRETARY WAITING AREA	1	120	120		
OPEN OFFICE FOR 5 ITERANTS	1	380	380		
DART OFFICE & STORAGE	1	400	400		
STAFF WORKROOM	1	260	260		
RESTROOMS	3	60	180		
			5,870		

ALLIANCE & RECONNECTION SERVICES: 7,165 SF EXISTING AREA

PROGRAM	QUANTITY	AREA (SF)	TOTAL (SF)	CLASS SIZE	NOTES
DEDICATED CLASSROOMS	10	900	9,000	15 STUDENTS	
CTE LAB: CULINARY ARTS / SCHOOL KITCHEN	1	1800	1,800		
PRIVATE OFFICES: PRINCIPAL, VP SOCIAL WORKER, COUNSELOR, SPED, RECONNECTION CENTER	7	80	560		
CONFERENCE ROOM	1	120	120		
SECRETARY WAITING AREA	1	240	240		
STAFF WORKROOM	1	260	260		COULD BE SHARED
FLEX/COMMONS	1	1800	1,800		COULD BE SHARED
RESTROOMS	2	250	500		
STAFF & GENDER NEUTRAL RESTROOM	2	60	120		
LAUNDRY ROOM	1	120	SHARED		
			14,400		

NOTES

- + Assumes programs share the following spaces with Benson Tech in all on-site scenarios: gyms, locker rooms, changing rooms, showers, commons, library/media center.
- + Sizes and quantity of classrooms and support spaces may vary due to existing conditions.
- + Sharing options for support spaces may be explored to mitigate impacts on approved Master Plan.

SCENARIO 1 / ALL BENSON TECH, NO MPG PROGRAMS ON-SITE

BOARD RESOLUTION PROVISIONS INCLUDED

- + Building size reduction (about 3,500 SF)
- + Space for future visual & performing arts program
- + ADA/Code compliant access to Buckman Fields
- + All programs and program spaces included:
 - + **Benson Tech: 1,700 design capacity**

IMPACTS TO APPROVED MASTER PLAN

- + Aligns with approved budget
- + No significant change to Master Plan
- + Assignment of “unassigned CTE space” would need to be determined
- + All MPG Programs would need alternative location(s) - separate effort being completed to study offsite locations.

SCENARIO 1 / UPPER LEVEL

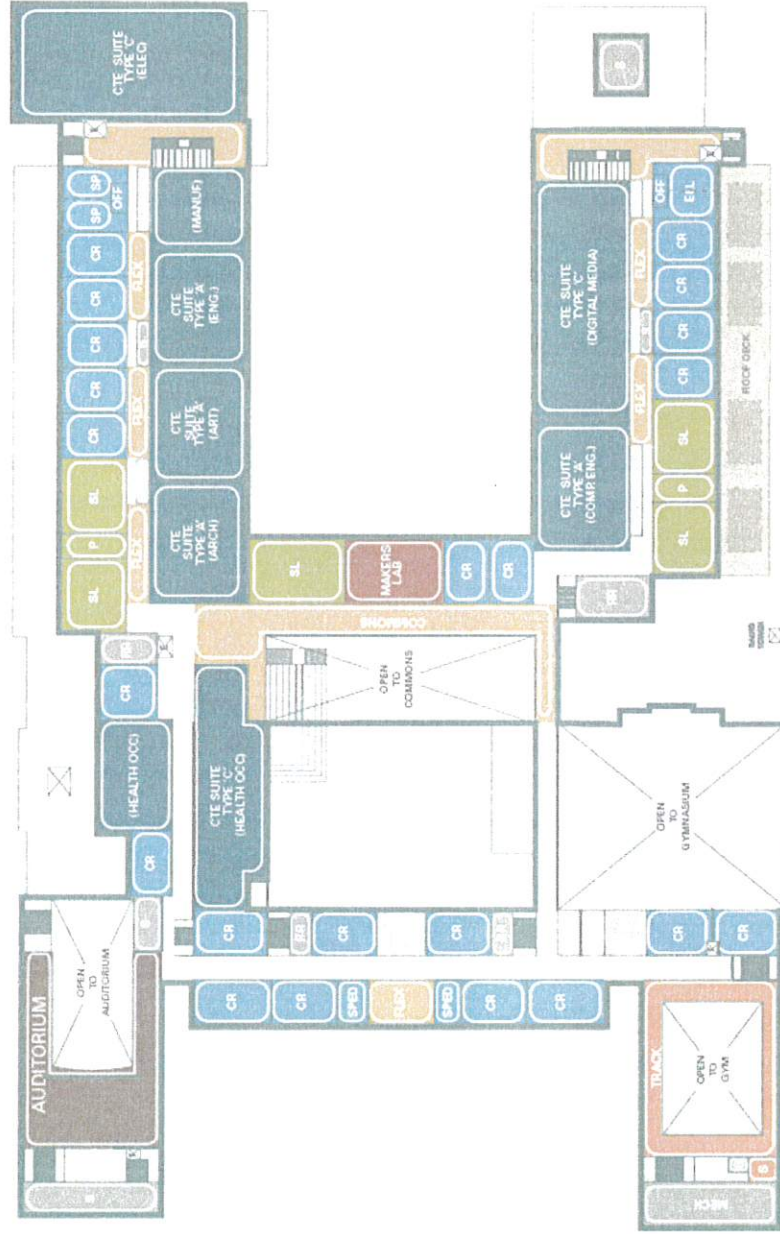

LEGEND

Yellow box	GATHERING SPACE	Green box	SL (STUDIO/LAB)	Dark blue box	PERFORMING ARTS
Blue box	CTE	Red box	ATHLETICS	Light blue box	SPECIALTY RESOURCE
Light blue box	CR (CLASSROOM)	Orange box	SUPPORT	Dark blue box	ADMIN RTP (RECEPTION)
Light blue box	SP (SPECIAL EDUCATION)	White box	OPEN TO GYM	White box	OPEN TO GYMNASIUM



SCENARIO 1 / LOWER LEVEL

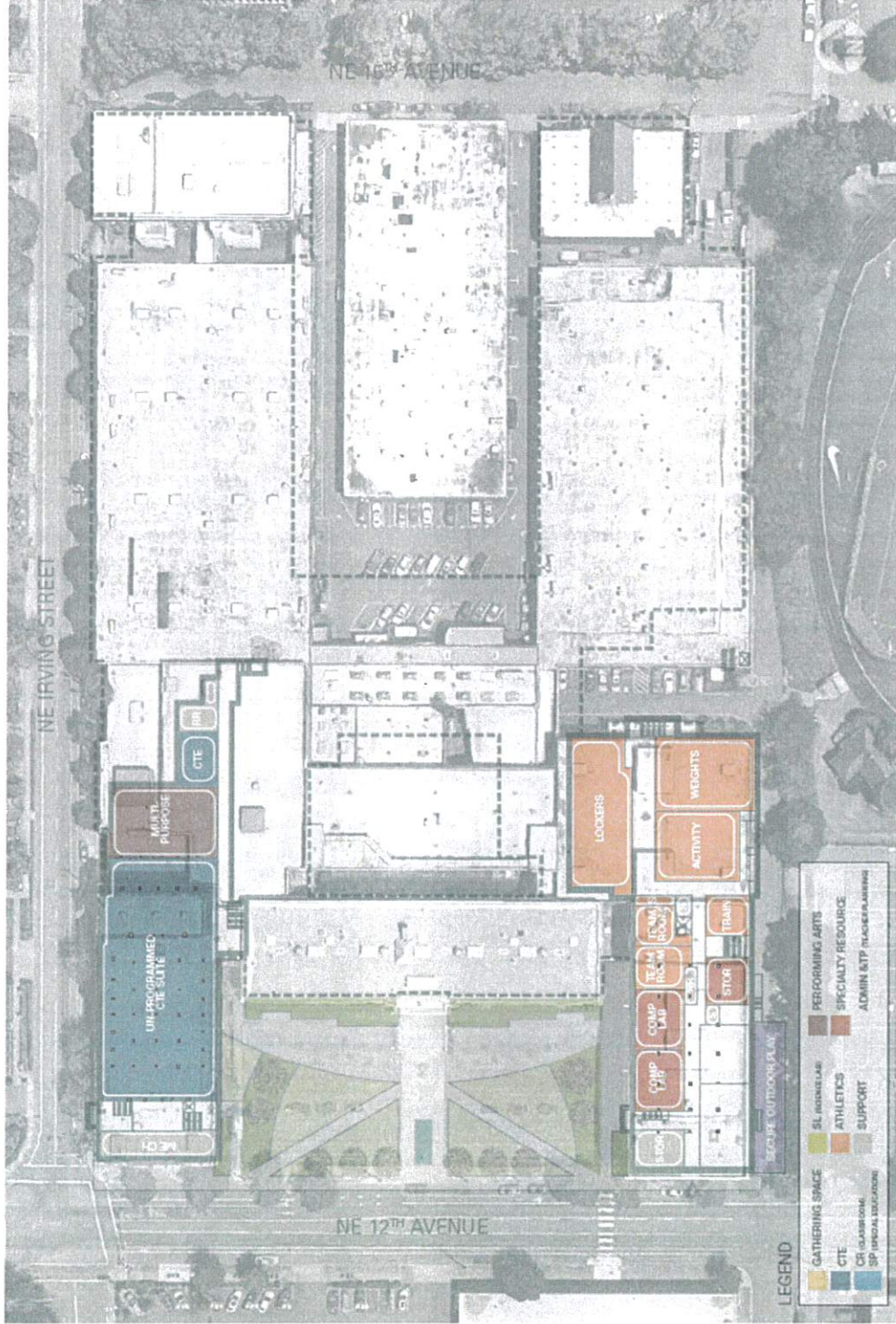

SCENARIO 2A / BENSON AND ALL MPG PROGRAMS ON-SITE

BOARD RESOLUTION PROVISIONS INCLUDED

- + ADA/Code compliant access to Buckman Fields
- + All programs and program spaces included:
 - + Benson Tech: 1,400 design capacity
 - + Alliance at Benson and Reconnection Services
 - + Virtual Scholars
 - + Night/Summer School Offices
 - + PISA
 - + Pioneer High School
 - + DART/Clinton School

IMPACTS TO APPROVED MASTER PLAN

- + Additional \$ beyond approved budget
- + Changes to Master Plan in affected areas:
 - Auditorium lower level, Auditorium balcony, Main building second floor
- + No additional CTE space for Benson Tech
- + 12 fewer teaching stations for Benson Tech
- + Spaces for independent schools (Alliance & DART/Clinton) in lower level with limited daylight
- + Freshman academy for Benson Tech would need to be relocated or dispersed
- + Reduced building and custodial storage

SCENARIO 2A / UPPER LEVEL

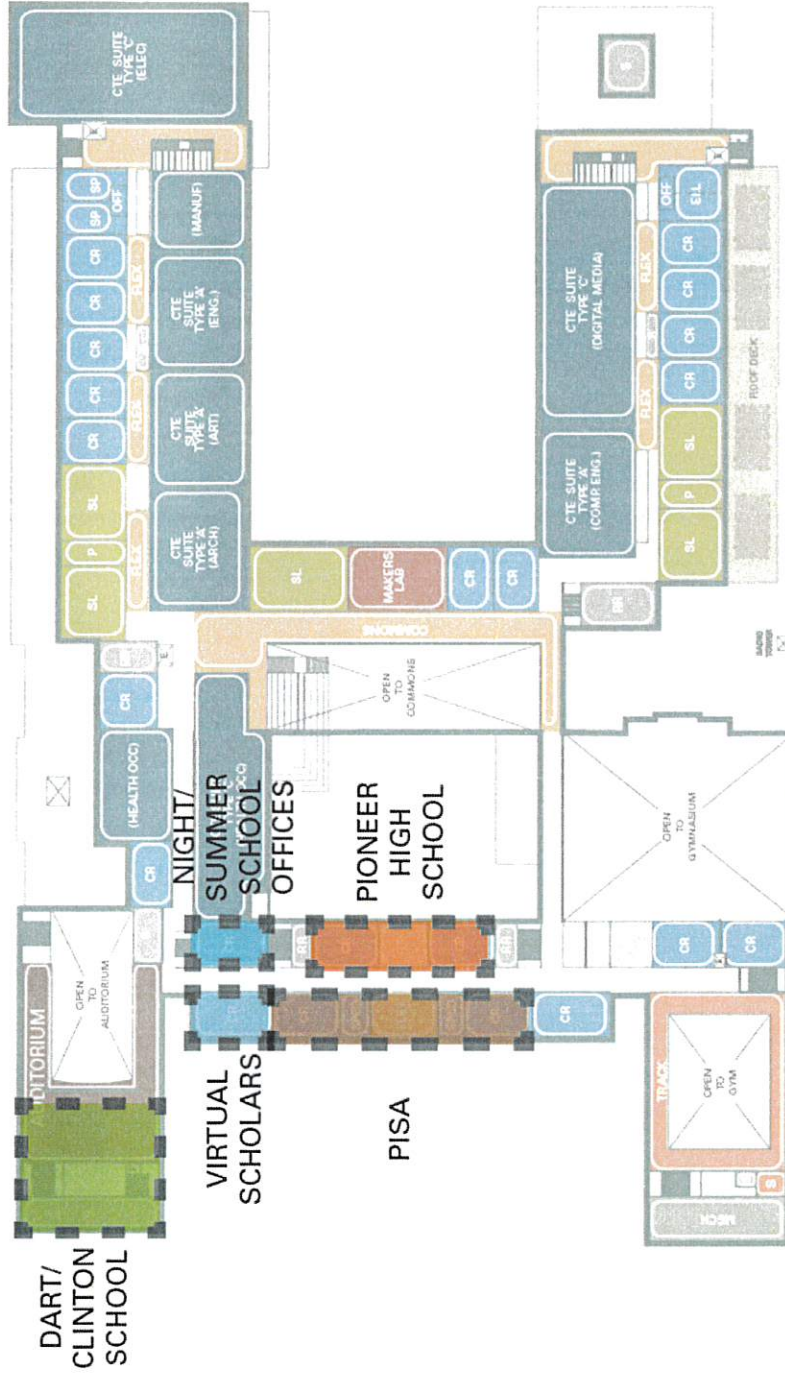

LEGEND

Light Green	GATHERING SPACE	Light Blue	PERFORMING ARTS
Light Blue	SL (SPECIAL LAB)	Dark Blue	SPECIALTY RESOURCE
Orange	ATHLETICS	Light Green	SUPPORT
Dark Blue	CR (CLASSROOM)	Light Blue	ADMIN BTP (BUSINESS TRAINING)
Light Green	SP (SPECIAL EDUCATION)	Light Blue	



SCENARIO 2B / BENSON AND ALL MPG PROGRAMS ON-SITE, ADDITIONAL CRS

BOARD RESOLUTION PROVISIONS INCLUDED

- + ADA/Code compliant access to Buckman Fields
- + All programs and program spaces included:
 - + Benson Tech: 1,550 design capacity
 - + Alliance at Benson and Reconnection Services
 - + Virtual Scholars
 - + Night/Summer School Offices
 - + PISA
 - + Pioneer High School
 - + DART/Clinton School

IMPACTS TO APPROVED MASTER PLAN

- + Additional \$\$ beyond approved budget
- + Changes to Master Plan in affected areas:
 - Auditorium lower level, Auditorium balcony, Main building second floor
- + No additional CTE space for Benson Tech
- + 6 fewer teaching stations for Benson Tech
- + Spaces for independent schools (Alliance & DART/Clinton) in lower level with limited daylight
- + Freshman academy for Benson Tech would need to be relocated or dispersed
- + Reduced building and custodial storage

SCENARIO 2B / UPPER LEVEL

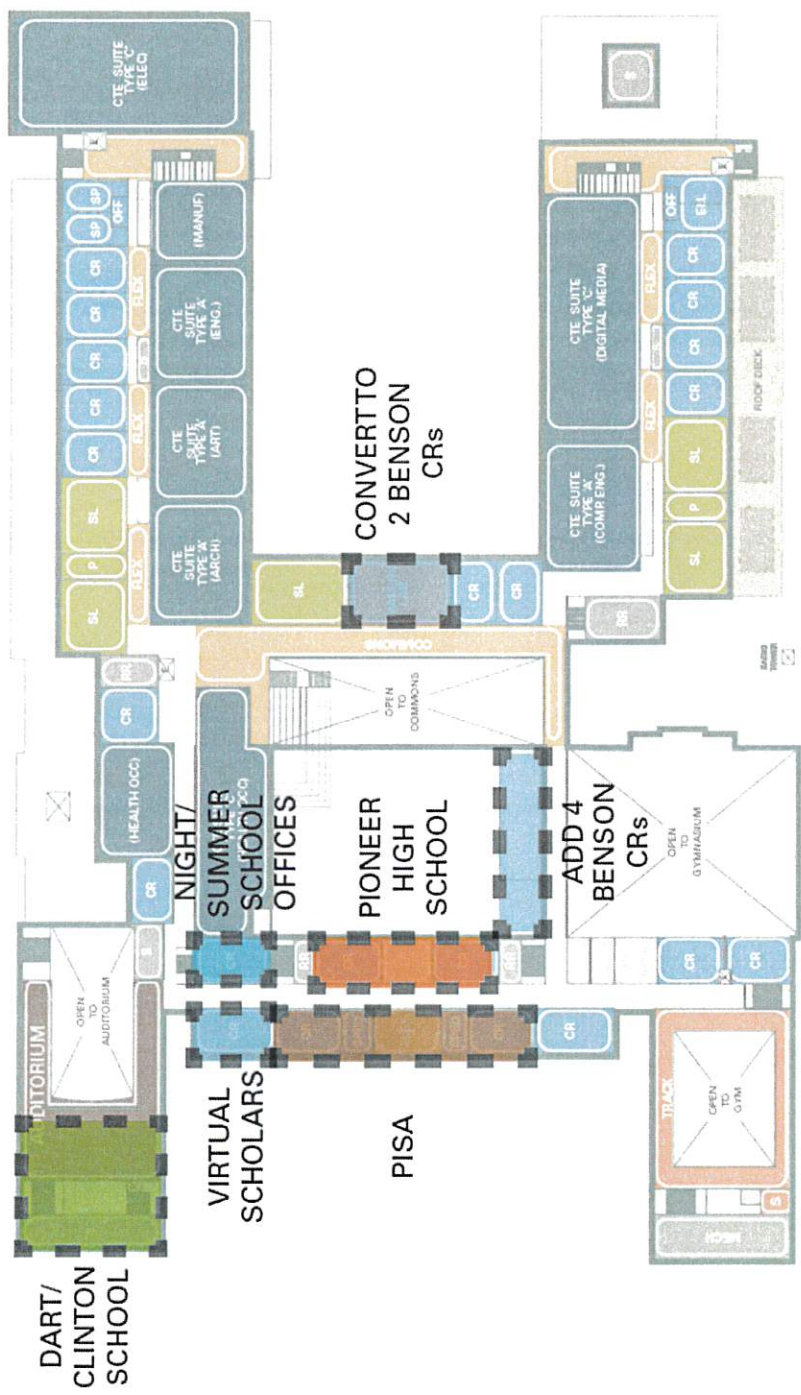

LEGEND

[Light Blue Box]	GATHERING SPACE	[Light Green Box]	SL - SCIENCE LAB	[Light Purple Box]	PERFORMING ARTS
[Light Orange Box]	CTE	[Light Yellow Box]	ATHLETICS	[Light Red Box]	SPECIALTY RESOURCE
[Light Green Box]	CR - CLASSROOM	[Light Blue Box]	SUPPORT	[Light Purple Box]	ADMIN / ITP / PLANNING
[Light Blue Box]	SP - SPECIAL EDUCATION				



SCENARIO 3A / BENSON TECH AND INTEGRATED MPG PROGRAMS ON-SITE

BOARD RESOLUTION PROVISIONS INCLUDED

- + Space for future visual & performing arts program
- + ADA/Code compliant access to Buckman Fields
- + All programs and program spaces included:
 - + Benson Tech: 1,550 design capacity
 - + Virtual Scholars
 - + Night/Summer School Offices
 - + PISA
 - + Pioneer High School

IMPACTS TO APPROVED MASTER PLAN

- + Aligns with approved budget
- + Changes to Master Plan in affected areas: Main building second floor
- + Assignment of “unassigned CTE space” would need to be determined
- + 6 fewer teaching stations for Benson Tech
- + Independent schools: Alliance and Reconnection Services, DART/Clinton School would need alternative location
- + Freshman academy for Benson Tech would need to be relocated or dispersed

SCENARIO 3A / UPPER LEVEL

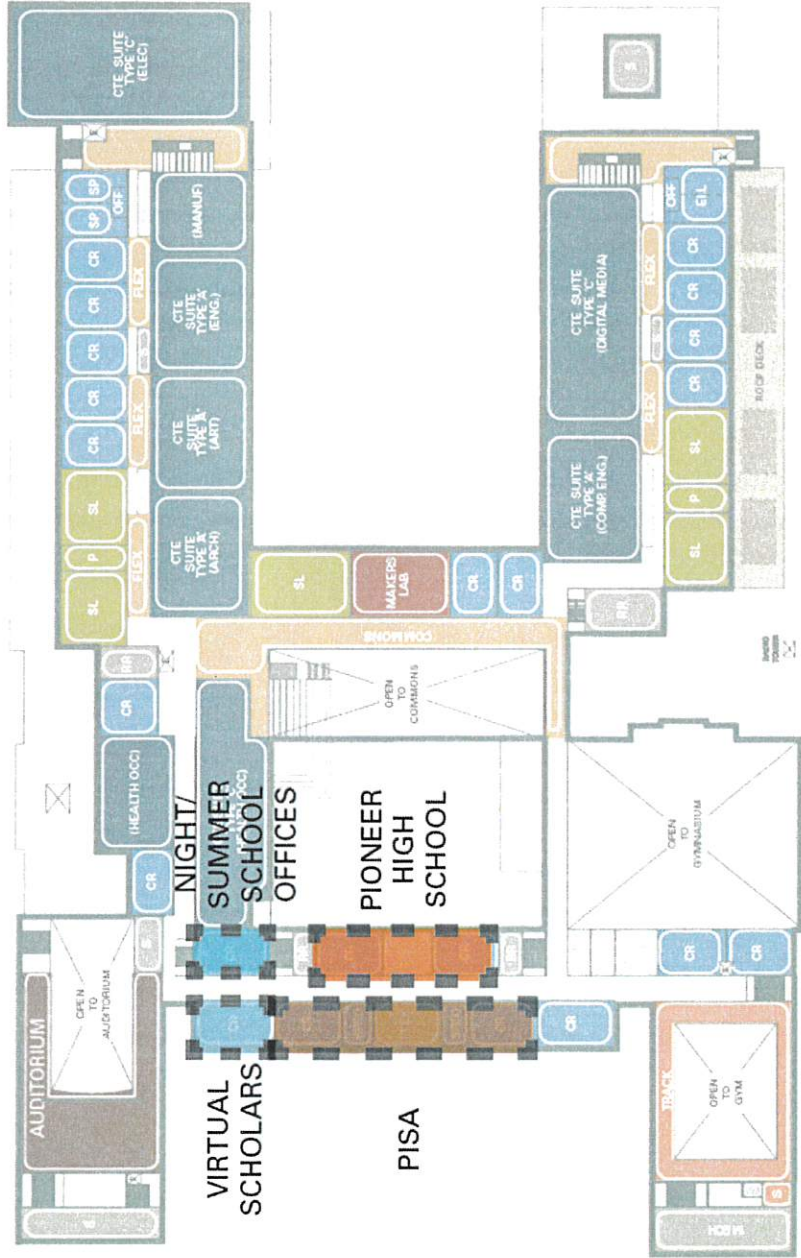

LEGEND

	GATHERING SPACE		SL STUDENT LAB		PERFORMING ARTS
	CTE		ATHLETICS		SPECIALTY RESOURCE
	CR CLASSROOM		SUPPORT		ADMIN & TP PLACEMENT
	SP SPECIAL EDUCATION				



SCENARIO 3B / BENSON TECH AND INTEGRATED MPG PROGRAMS ON-SITE, ADDITIONAL CRS

BOARD RESOLUTION PROVISIONS INCLUDED

- + Space for future visual & performing arts program
- + ADA/Code compliant access to Buckman Fields
- + All programs and program spaces included:
 - + Benson Tech: 1,700 design capacity
 - + Virtual Scholars
 - + Night/Summer School Offices
 - + PISA
 - + Pioneer High School

IMPACTS TO APPROVED MASTER PLAN

- + Additional \$\$ beyond approved budget
- + Changes to Master Plan in affected areas: Main building second floor
- + Assignment of "unassigned CTE space" would need to be determined
- + No fewer teaching stations for Benson Tech
- + Independent schools: Alliance and Reconnection Services, DART/Clinton School would need alternative location

SCENARIO 3B / UPPER LEVEL

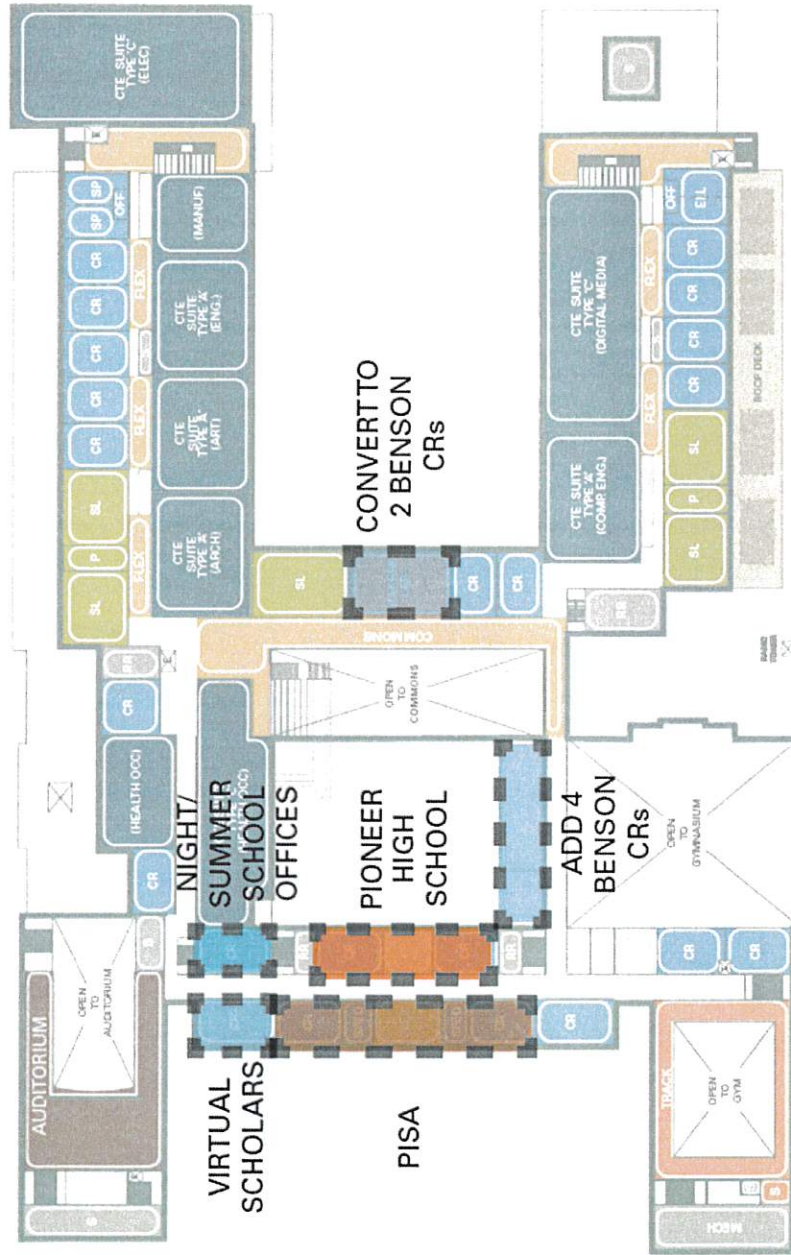

LEGEND

	GATHERING SPACE		PERFORMING ARTS
	SL (STRUCTURAL)		SPECIALTY RESOURCE
	ATHLETICS		ADMIN. & TP (TEACHING ASSISTANTS)
	CR (CLASSROOM)		SUPPORT
	SP (SPECIAL EDUCATION)		



SCENARIO 3C / BENSONTECH AND INTEGRATED MPG PROGRAMS ON-SITE

BOARD RESOLUTION PROVISIONS INCLUDED

- + ADA/Code compliant access to Buckman Fields
- + All programs and program spaces included:
 - + Benson Tech: 1,550 design capacity
 - + Virtual Scholars
 - + Night/Summer School Offices
 - + PISA
 - + Pioneer High School

IMPACTS TO APPROVED MASTER PLAN

- + Aligns with approved budget
- + Changes to Master Plan in affected areas: Auditorium lower level
- + No additional CTE space for Benson Tech
- + 6 fewer teaching stations for Benson Tech
- + Independent schools: Alliance and Reconnection Services, DART/Clinton School would need alternative location

SCENARIO 3C / UPPER LEVEL

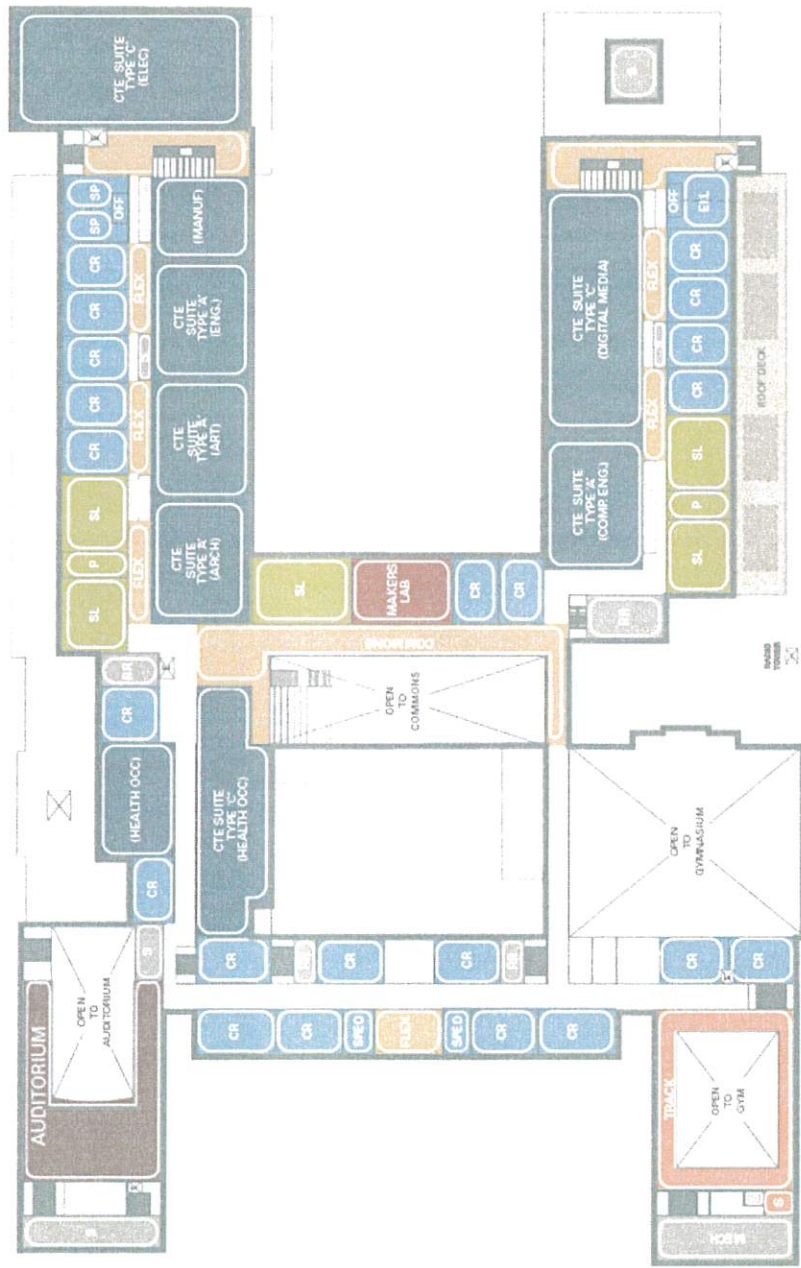

LEGEND

	GATHERING SPACE		SL (SPECIALTY RESOURCE)		PERFORMING ARTS
	CTE		ATHLETICS		SPECIALTY RESOURCE
	CR (CLASSROOM)		SUPPORT		ADMIN & TP (TECHNICAL ASSISTANT)
	SP (SPECIAL EDUCATION)				



SCENARIO 3C / LOWER LEVEL

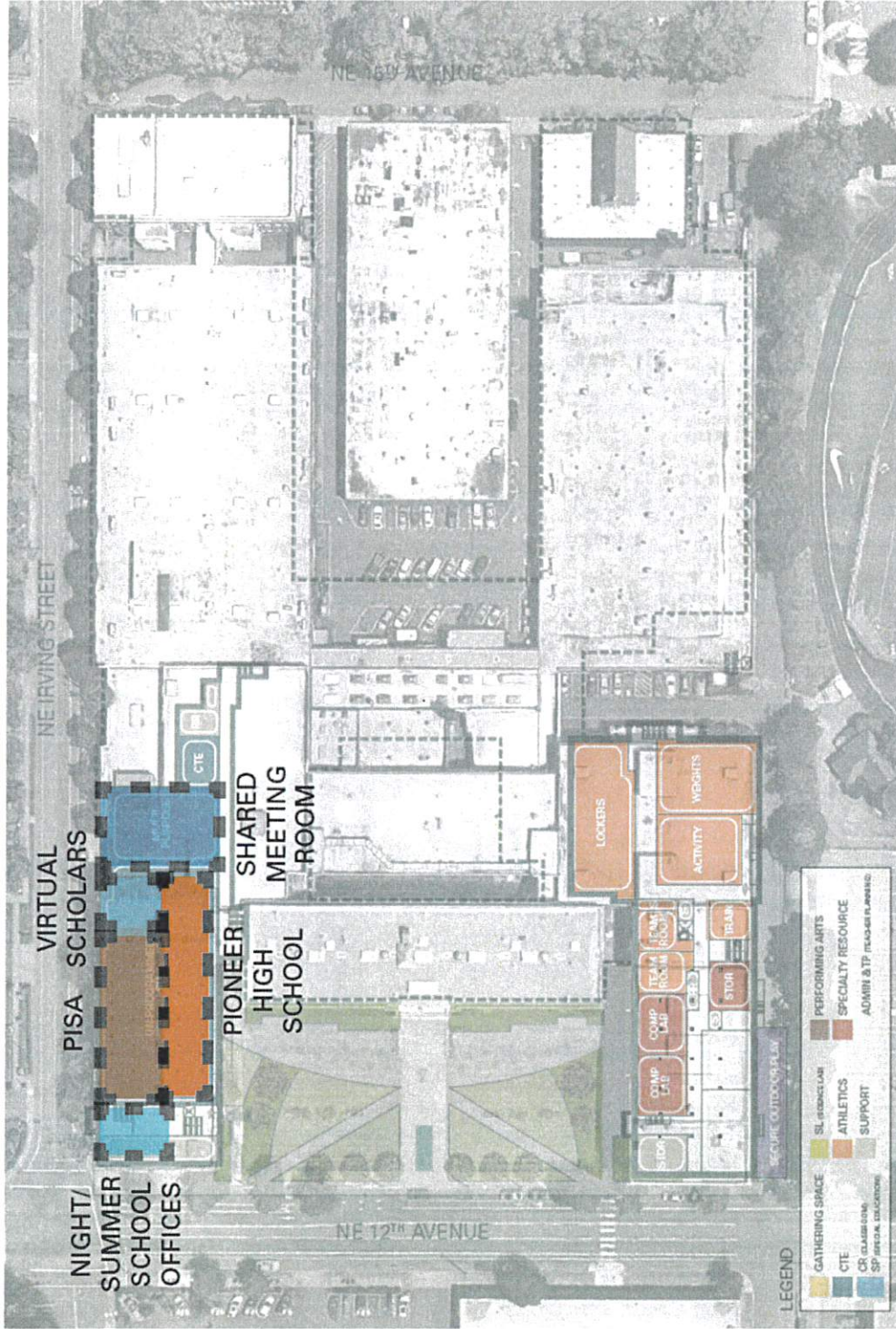

SCENARIO 3D / BENSONTECH AND INTEGRATED MPG PROGRAMS ON-SITE, ADDITIONAL CRS

BOARD RESOLUTION PROVISIONS INCLUDED

- + ADA/Code compliant access to Buckman Fields
- + All programs and program spaces included:
 - + Benson Tech: 1,700 design capacity
 - + Virtual Scholars
 - + Night/Summer School Offices
 - + PISA
 - + Pioneer High School

IMPACTS TO APPROVED MASTER PLAN

- + Additional \$\$ beyond approved budget
- + Changes to Master Plan in affected areas: Auditorium lower level
- + No additional CTE space for Benson Tech
- + No fewer teaching stations for Benson Tech
- + Independent schools: Alliance and Reconnection Services, DART/Clinton School would need alternative location

SCENARIO 3D / UPPER LEVEL

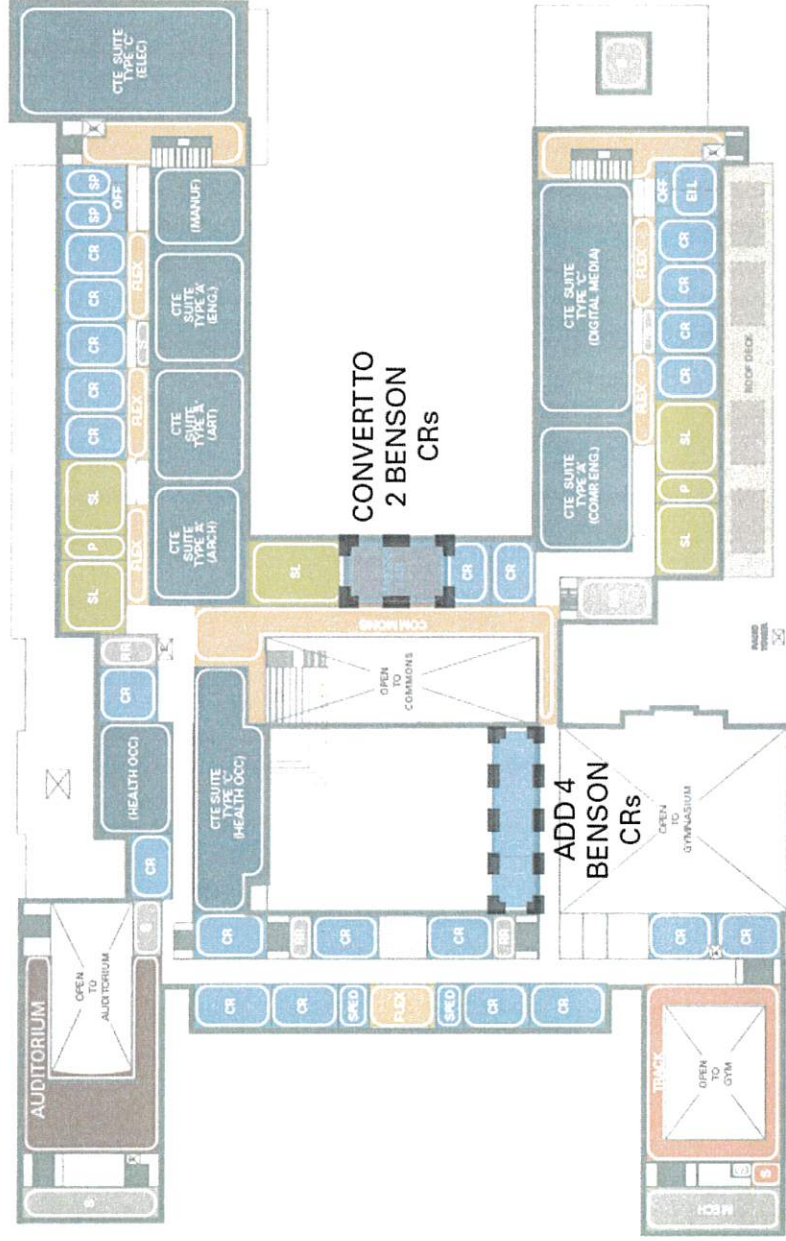

LEGEND

[Light Blue Box]	GATHERING SPACE	[Light Green Box]	SL (STUDENT LAB)	[Light Purple Box]	PERFORMING ARTS
[Light Orange Box]	ATHLETICS	[Light Yellow Box]	ATHLETICS	[Light Blue Box]	SPECIALTY RESOURCE
[Light Green Box]	SUPPORT	[Light Blue Box]	CR (CLASSROOM)	[Light Purple Box]	ADMIN & TP (TECHNOLOGY)
[Light Blue Box]	SUPPORT	[Light Blue Box]	SP (SPECIAL EDUCATION)	[Light Purple Box]	ADMIN & TP (TECHNOLOGY)



SCENARIO 3D / LOWER LEVEL

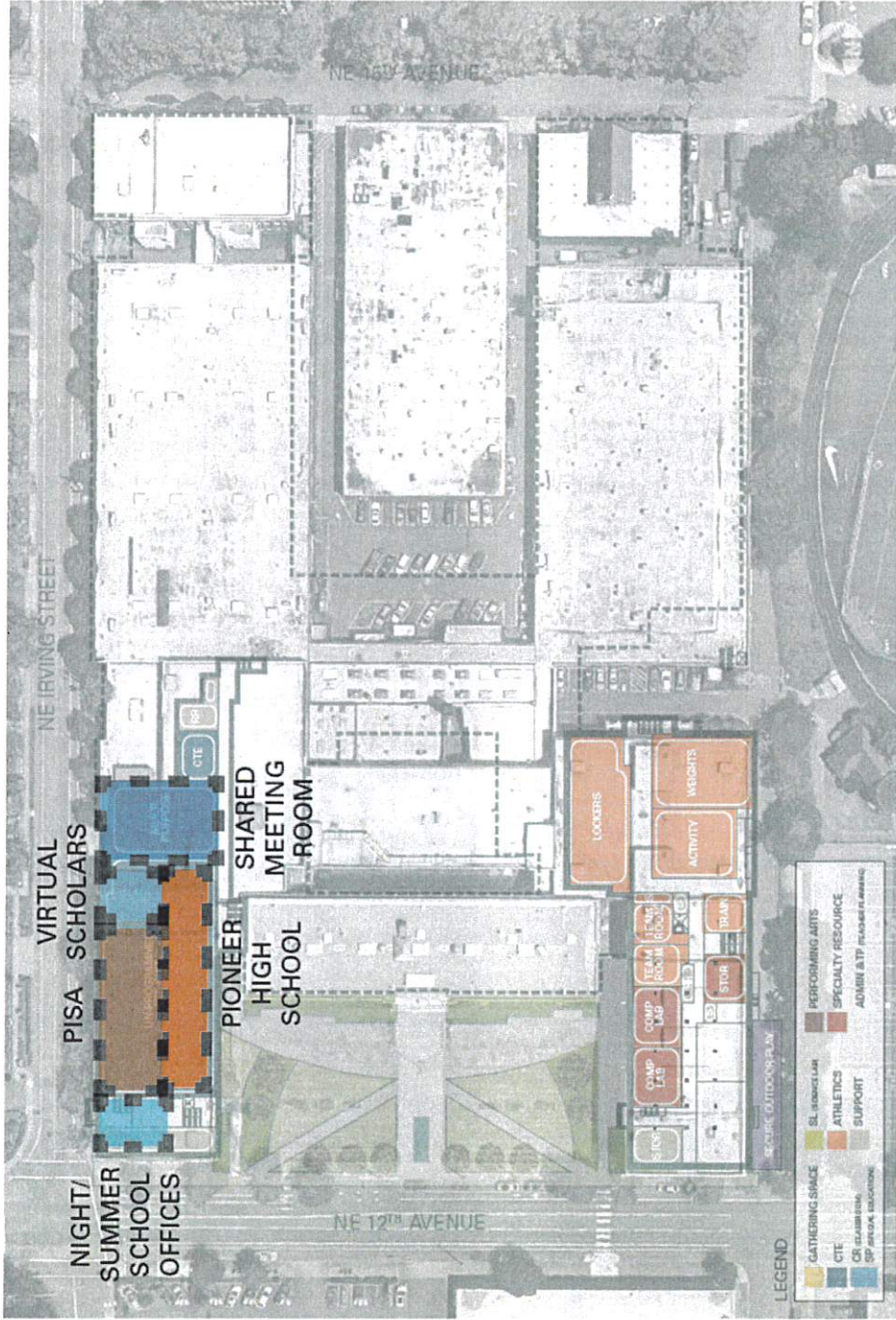

SCENARIO 4A / BENSON TECH AND INTEGRATED MPG PROGRAMS ON-SITE, INDEPENDENT SCHOOLS ON ADJACENT PARKING SITE

BOARD RESOLUTION PROVISIONS INCLUDED

- + Space for future visual & performing arts program
- + ADA/Code compliant access to Buckman Fields
- + All programs and program spaces included:
 - + Benson Tech: 1,550 design capacity
 - + Virtual Scholars
 - + Night/Summer School Offices
 - + PISA
 - + Pioneer High School

IMPACTS TO APPROVED MASTER PLAN

- + Additional \$\$\$ beyond approved budget
- + Changes to Master Plan in affected areas: Main building second floor
- + Assignment of "unassigned CTE space" would need to be determined
- + 6 fewer teaching stations for Benson Tech
- + Independent schools: Alliance and Reconnection Services, DART/Clinton School on adjacent parking site
- + Freshman academy for Benson Tech would need to be relocated or dispersed
- + Reduced parking capacity

SCENARIO 4A / SITE PLAN

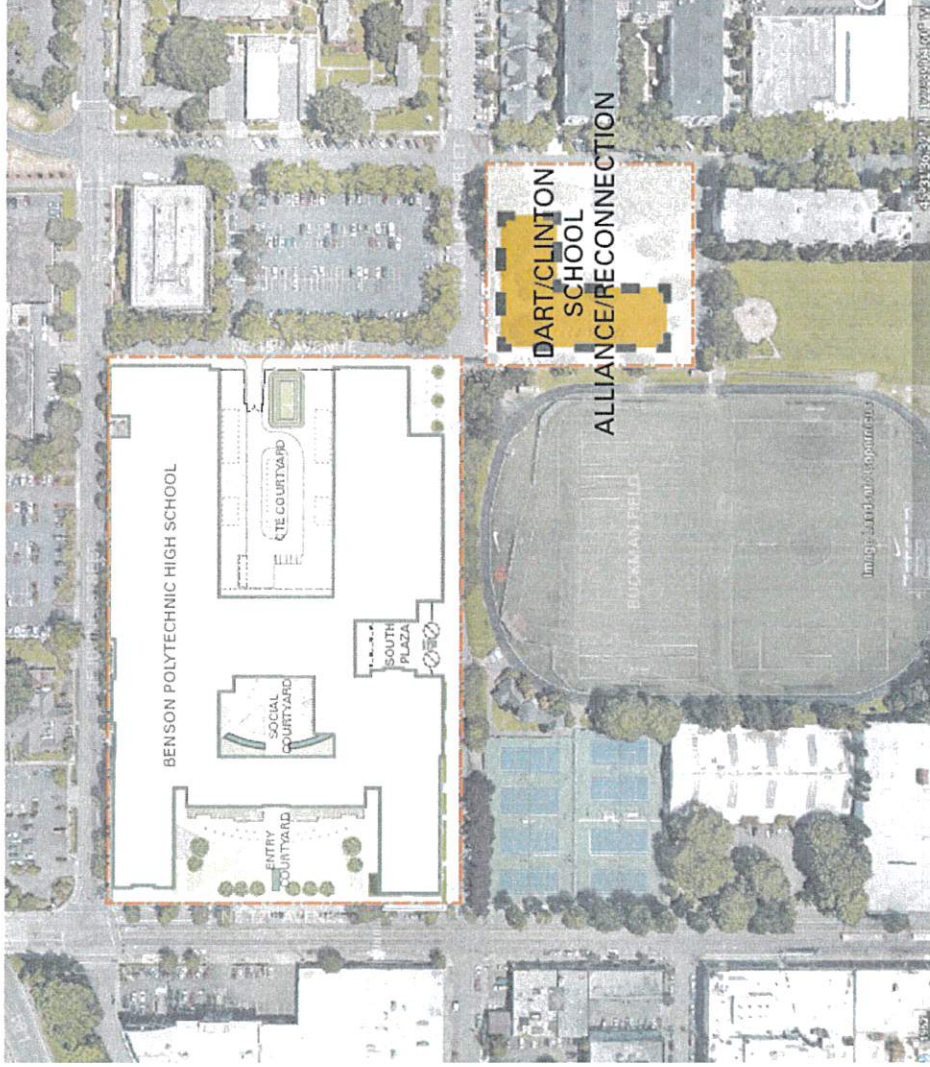

SCENARIO 4A / UPPER LEVEL

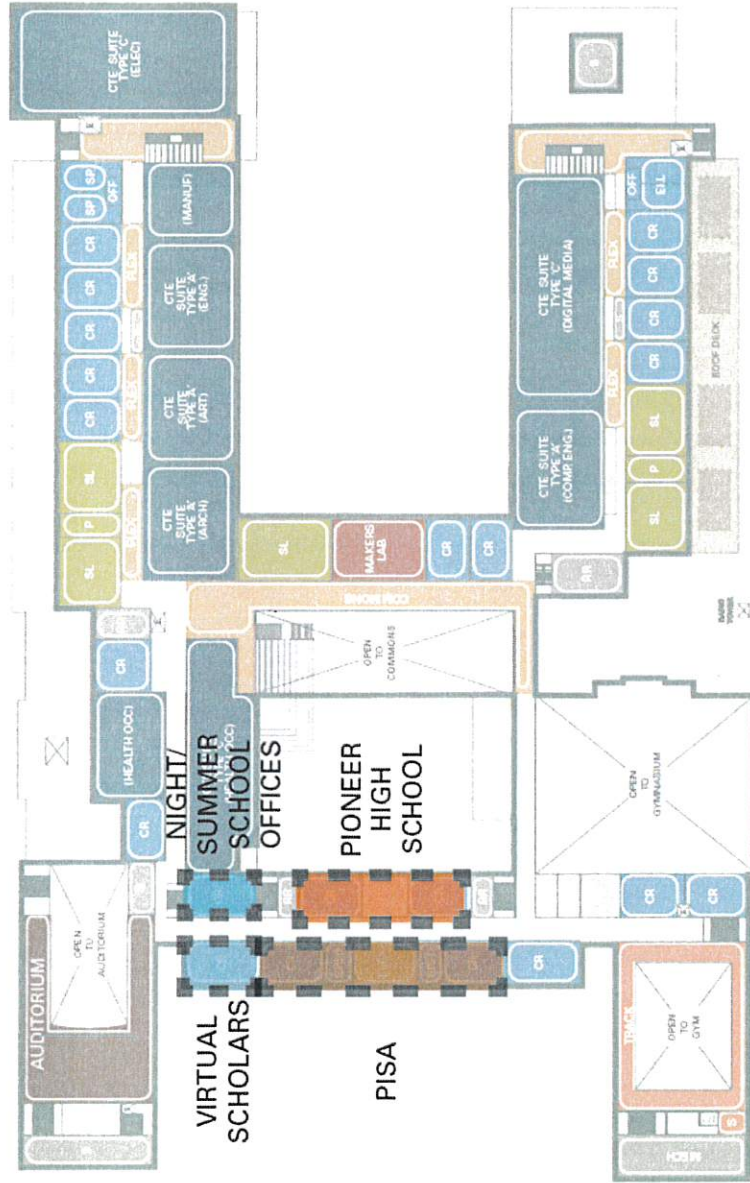

LEGEND

Yellow square	GATHERING SPACE	Green square	SL (STEINER LAB)	Blue square	PERFORMING ARTS
Blue square	CTE	Orange square	ATHLETICS	Red square	SPECIALTY RESOURCE
Light blue square	CR (CLASSROOM)	Light green square	SUPPORT	Dark red square	ADMIN & TP (TRAINED PERSONNEL)
Light blue square	SP (SPECIAL EDUCATION)				



SCENARIO 4B / BENSON TECH AND INTEGRATED MPG PROGRAMS ON-SITE, ADDITIONAL CRS INDEPENDENT SCHOOLS ON ADJACENT PARKING SITE

BOARD RESOLUTION PROVISIONS INCLUDED

- + Space for future visual & performing arts program
- + ADA/Code compliant access to Buckman Fields
- + All programs and program spaces included:
 - + Benson Tech: 1,700 design capacity
 - + Virtual Scholars
 - + Night/Summer School Offices
 - + PISA
 - + Pioneer High School

IMPACTS TO APPROVED MASTER PLAN

- + Additional \$\$\$\$ beyond approved budget
- + Changes to Master Plan in affected areas: Main building second floor
- + Assignment of “unassigned CTE space” would need to be determined
- + No fewer teaching stations for Benson Tech
- + Independent schools: Alliance and Reconnection Services, DART/Clinton School on adjacent parking site
- + Freshman academy for Benson Tech would need to be relocated or dispersed
- + Reduced parking capacity

SCENARIO 4B / UPPER LEVEL

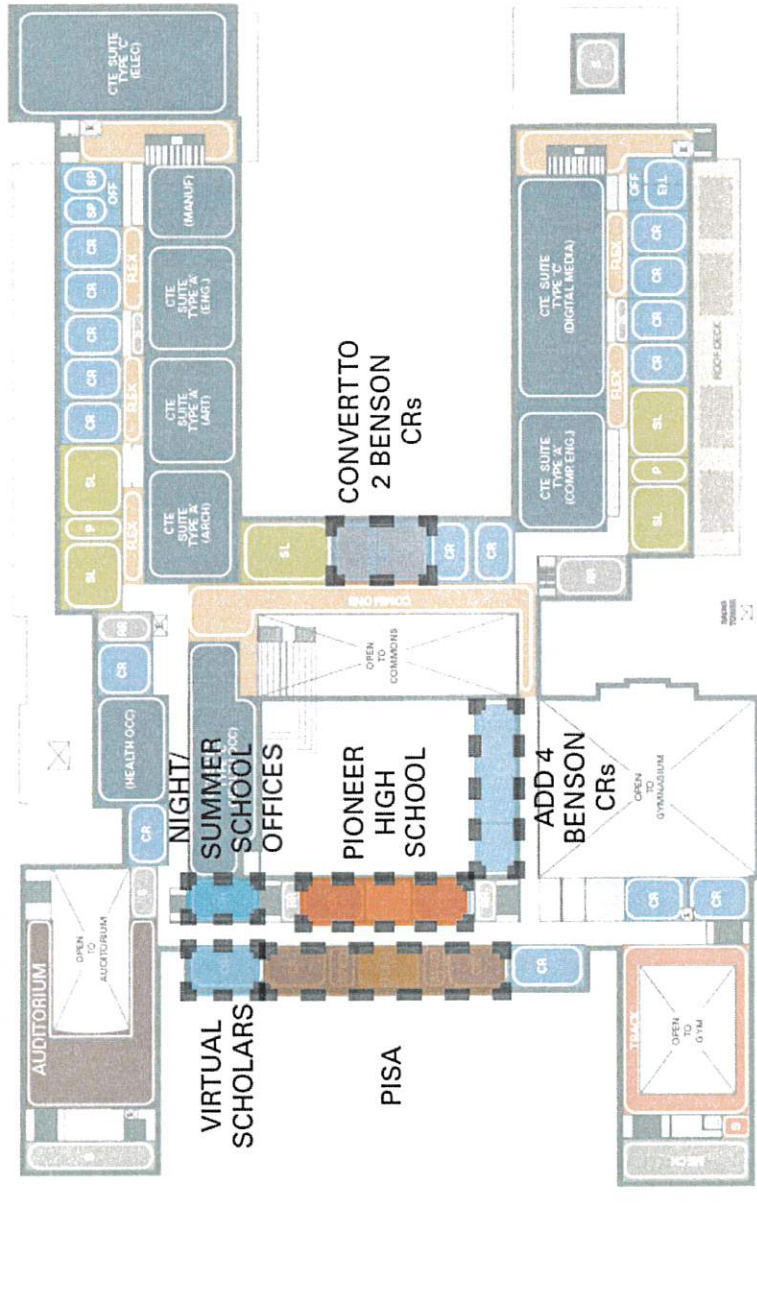

LEGEND

Light Blue	GATHERING SPACE	Light Green	SL (SPECIALIZED)	Dark Blue	PERFORMING ARTS
Dark Blue	CTE	Orange	ATHLETICS	Red	SPECIALTY RESOURCE
Light Blue	CR (CLASSROOM)	Light Blue	SUPPORT	Light Blue	ADMIN. & TP (TEACH PLANNING)
Light Blue	SP (SPECIAL EDUCATION)				



SCENARIO 4C / BENSON TECH AND INTEGRATED MPG PROGRAMS ON-SITE, INDEPENDENT SCHOOLS ON ADJACENT PARKING SITE

BOARD RESOLUTION PROVISIONS INCLUDED

- + ADA/Code compliant access to Buckman Fields
- + All programs and program spaces included:
 - + Benson Tech: 1,550 design capacity
 - + Virtual Scholars
 - + Night/Summer School Offices
 - + PISA
 - + Pioneer High School

IMPACTS TO APPROVED MASTER PLAN

- + Additional \$\$\$ beyond approved budget
- + Changes to Master Plan in affected areas: Auditorium lower level
- + No additional CTE space for Benson Tech
- + 6 fewer teaching stations for Benson Tech
- + Independent schools: Alliance and Reconnection Services, DART/Clinton School on adjacent parking site
- + Reduced parking capacity

SCENARIO 4C / UPPER LEVEL

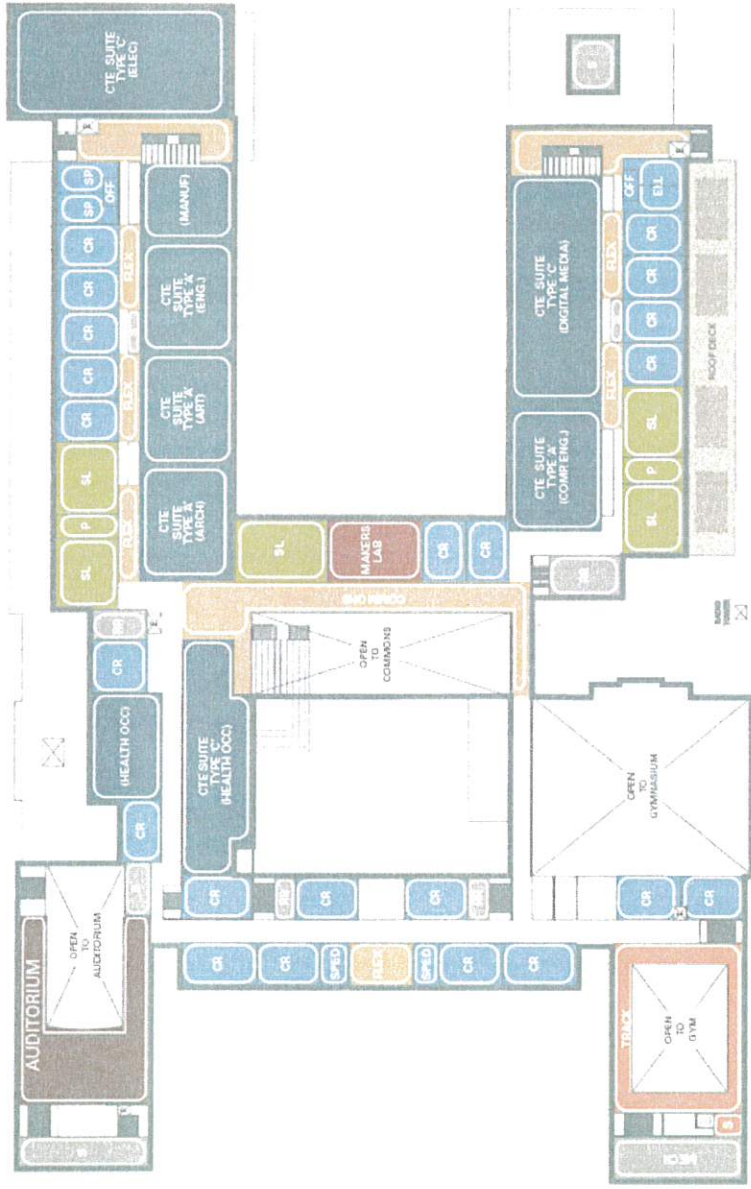

LEGEND

	GATHERING SPACE		SL (WORK/LAB)		PERFORMING ARTS
	CTE		ATHLETICS		SPECIALTY RESOURCE
	CR (CLASSROOM)		SUPPORT		ADMIN & IT / TRAINING
	SP (SPECIAL RESOURCE)				



SCENARIO 4D / BENSONTECH AND INTEGRATED MPG PROGRAMS ON-SITE, ADDITIONAL CRS INDEPENDENT SCHOOLS ON ADJACENT PARKING SITE

BOARD RESOLUTION PROVISIONS INCLUDED

- + ADA/Code compliant access to Buckman Fields
- + All programs and program spaces included:
 - + Benson Tech: 1,700 design capacity
 - + Virtual Scholars
 - + Night/Summer School Offices
 - + PISA
 - + Pioneer High School

IMPACTS TO APPROVED MASTER PLAN

- + Additional \$\$\$\$ beyond approved budget
- + Changes to Master Plan in affected areas: Auditorium lower level
- + No additional CTE space for Benson Tech
- + No fewer teaching stations for Benson Tech
- + Independent schools: Alliance and Reconnection Services, DART/Clinton School on adjacent parking site
- + Reduced parking capacity

SCENARIO 4D / UPPER LEVEL

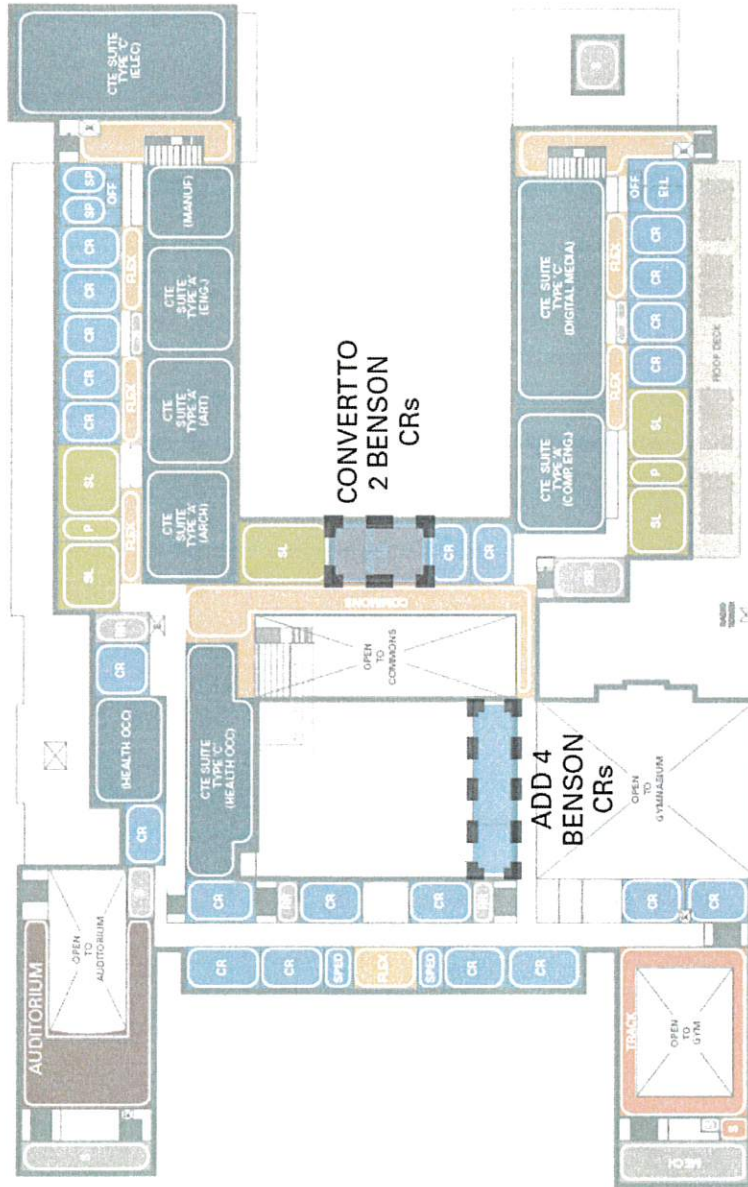

LEGEND

	GATHERING SPACE		SL (Special Lab)		PERFORMING ARTS
	CTE		ATHLETICS		SPECIALTY RESOURCE
	CR (Classroom)		SUPPORT		ADMIN & IT (Special numbers)
	SP (Special Lab/Prep)				

